

CFORCE 400 G2

Winch Mount PART #102065

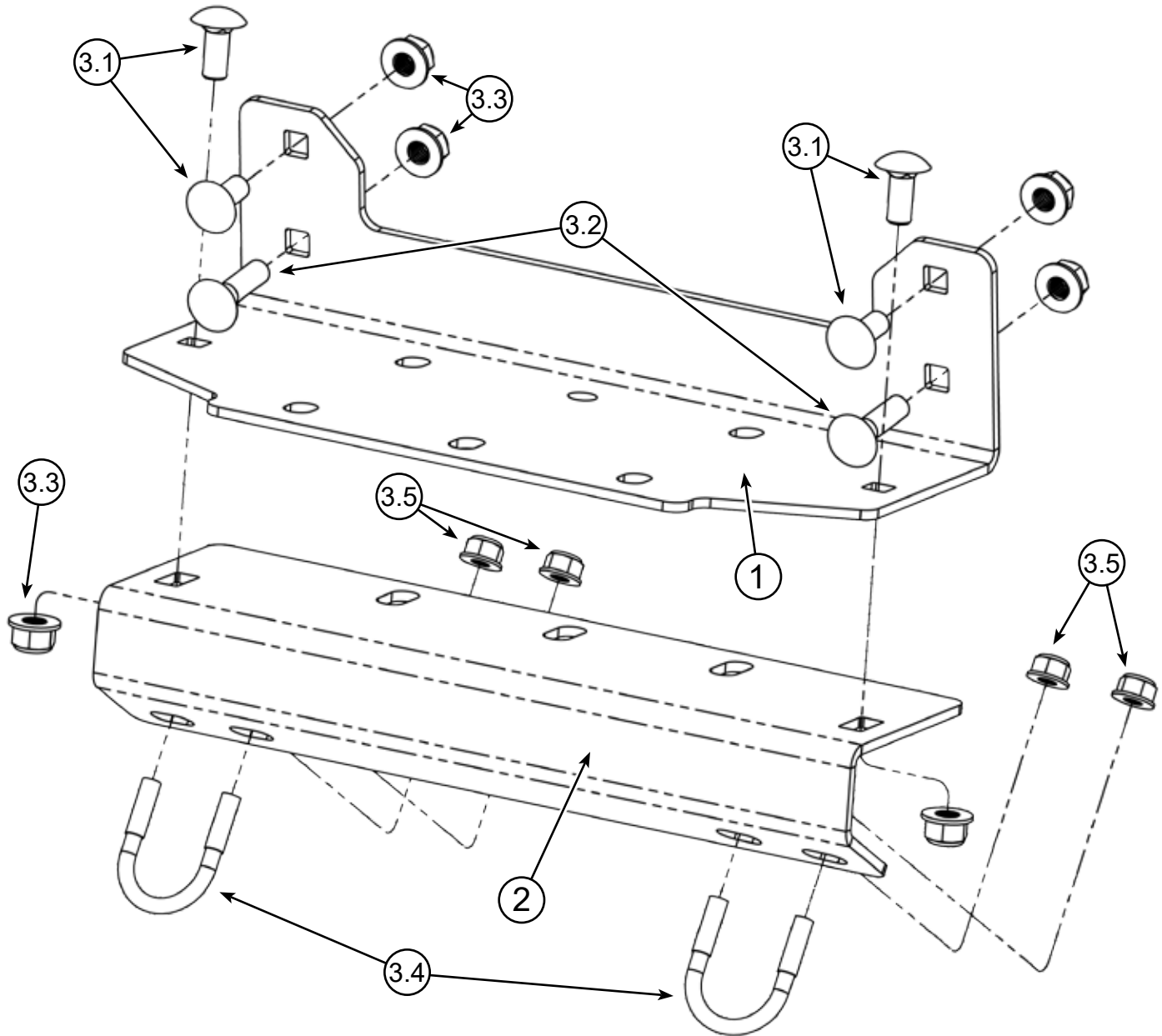

Kit Components:

Item #	Qty.	Description	Item #	Qty.	Description
1	1	Winch Mount	3.2	2	5/16"-18 X 1.25" Carriage Bolt GR5 Zinc
2	1	Winch Bracket	3.3	6	5/16"-18 Hex Nut Flanged Nylock GR5 Zinc
3	1	Hardware Kit HK-434	3.4	2	1/4"-20 X 1" X 1.5" U-Bolt Zinc 3/4" Thread Zinc
3.1	4	5/16"-18 X 3/4" Carriage Bolt Short Neck GR5 Zinc	3.5	4	1/4"-20 Hex Nut Flange Nylock GR5 Zinc



INSTALLATION INSTRUCTIONS

Note: Make sure all hardware needed to complete this mount is in the package. Thoroughly read through and understand the instructions before installing.

1. Remove Bolts (A & B) shown in **Figure 1** and remove the front fascia from the machine. These components will be reinstalled later.
2. Remove Bolts (C) from the fairlead location as shown in **Figure 1**. This hardware will be reused in a later step.
3. Remove Bolts (D) from both sides of the machine, to allow the front bumper to be pulled out a little ways from the bottom frame. This hardware will be reinstalled later. See **Figure 2**.
4. Place Winch Mount (1) and Winch Bracket (2) between the bumper and frame of the machine. Secure with Bolts (3.1 & 3.2) and Nuts (3.3) as shown in **Figure 3**. Make sure that this hardware is loosely installed.

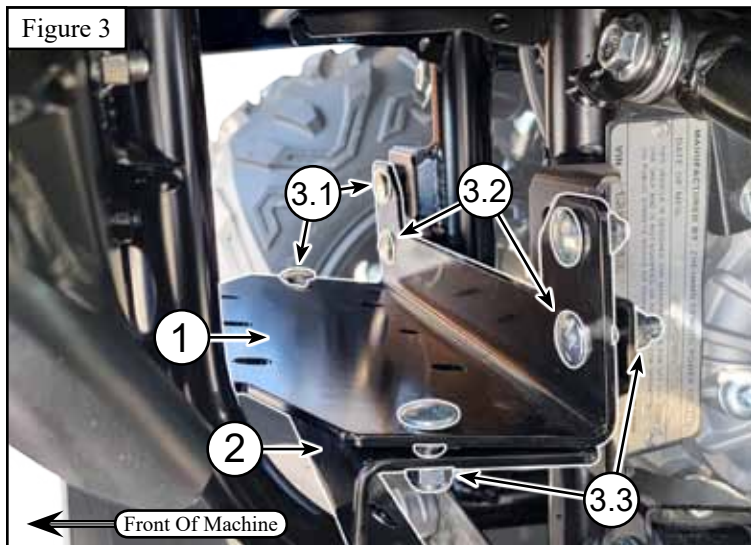

5. Pull enough cable out of the winch to feed it through the fairlead opening. Then pull the bumper forward enough to slide the winch in from the side. Loosely install the winch mounting bolts that come with the winch. See **Figure 4**.
6. Reinstall the lower bumper Bolts (D) removed in Step 3. Then install the U-Bolts (3.4) around the bumper bars and through the winch bracket (2). Loosely secure the U-Bolts with Nuts (3.5). See **Figure 4**.

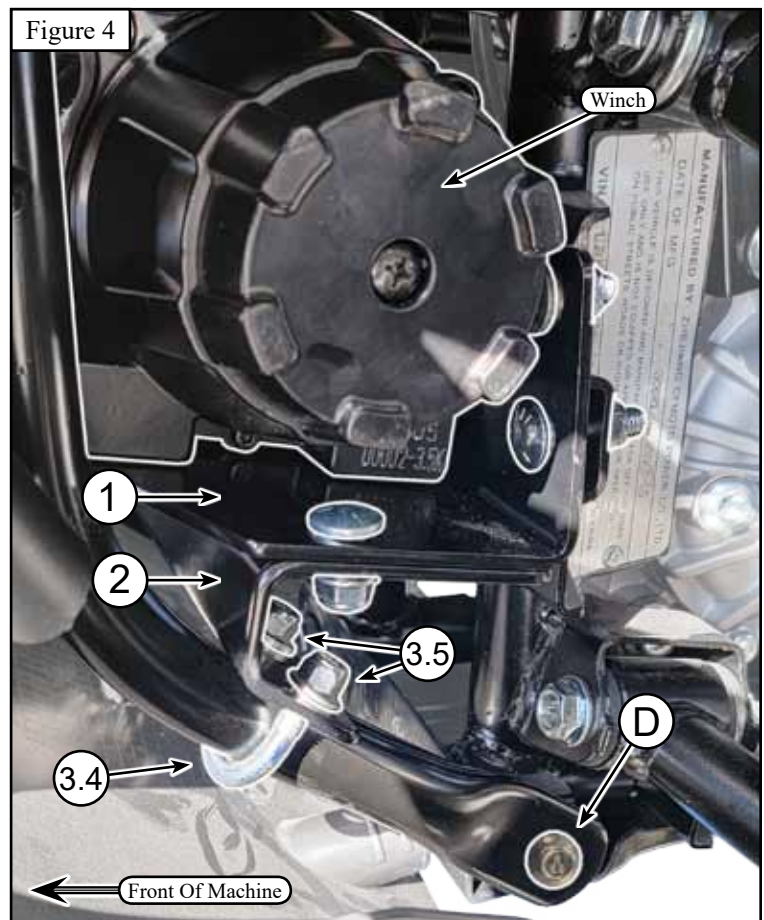
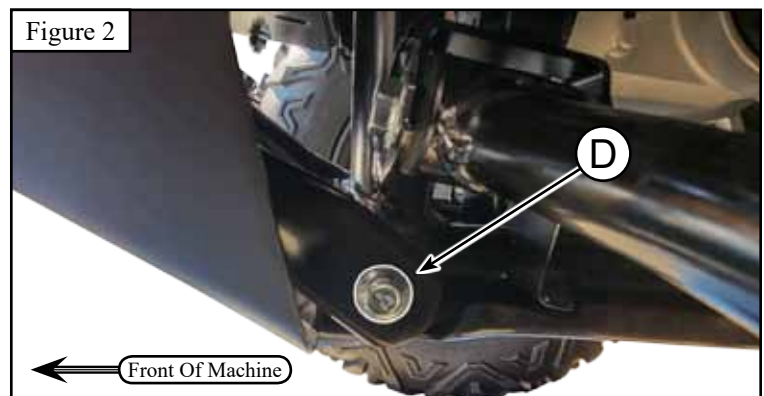
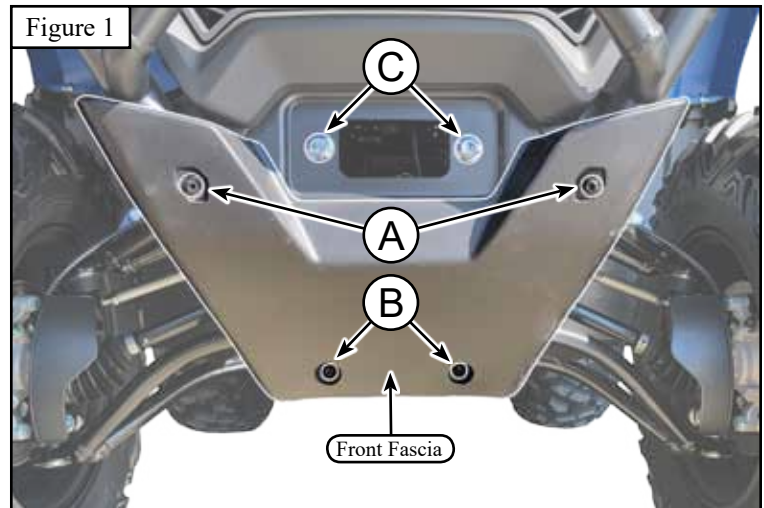

INSTALLATION INSTRUCTIONS

7. Tighten all **installed** hardware evenly, including winch hardware. See **Figures 3 & 4**.

Note: Do not over-tighten your winch hardware. Use the torque specs found in your winch manual.

8. Reinstall the front fascia and original hardware (A & B) removed in Step 1 as shown in **Figure 5**. Tighten evenly.
9. Pull your winch cable through the fairlead and secure the fairlead with Bolts (C) removed in Step 2. Make sure both bolts are installed before you tighten them evenly. See **Figure 5**.

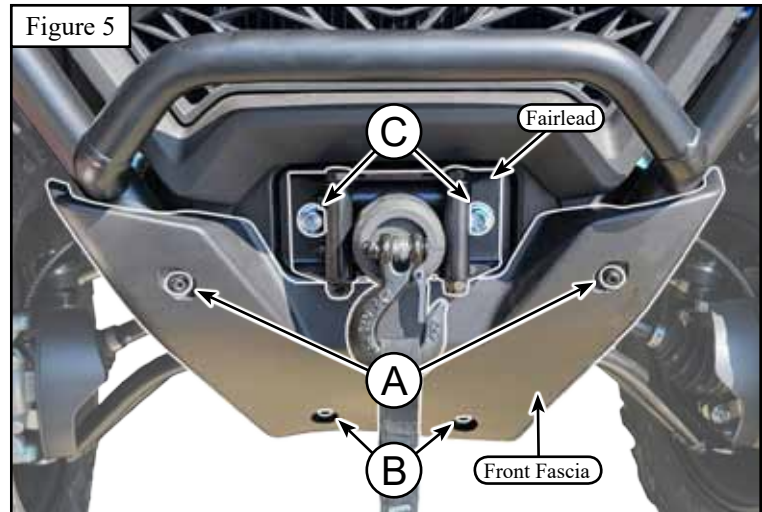

Wiring Information

1. The battery is located under the seat on this machine as shown in **Figure 6**.
2. Use the wiring diagram in the winch manual to see how the winch and controllers are wired.
3. When checking for an ignition controlled power wire, use a test light to verify that the wire you are using has power when the key is on and deactivates when the ignition is off.

