

BRUTE FORCE 450

PLOW MOUNT

PART #106560 Rev A

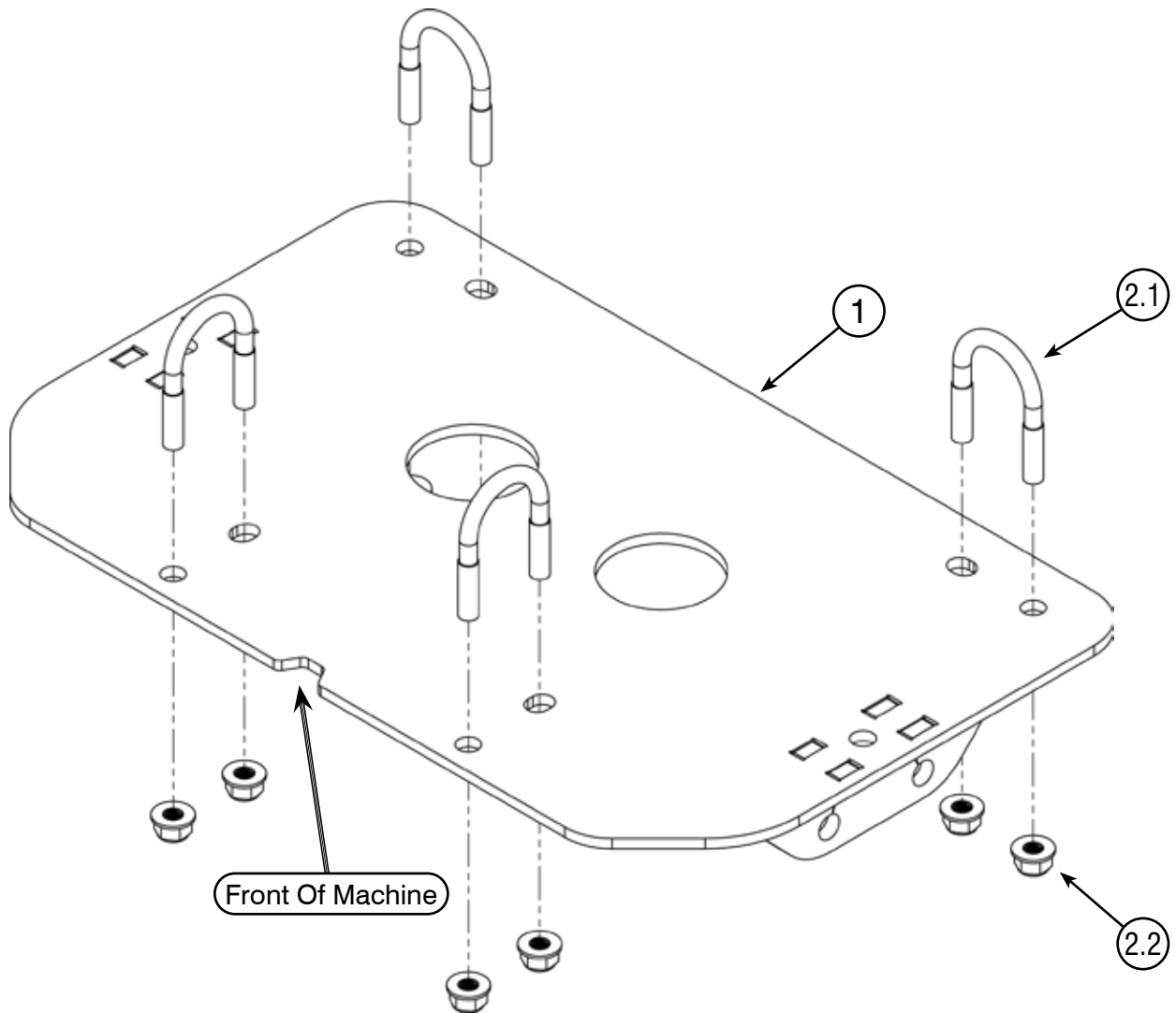

| Kit Components: | | |
|-----------------|------|---|
| Item # | Qty. | Description |
| 1 | 1 | Plow Mount Brute Force 450 (106553) |
| 2 | 1 | Hardware Kit (HK-111) |
| 2.1 | 4 | 5/16"-18 X 1.25" X 2.00" U-Bolt Zinc 1.00" Thread |
| 2.2 | 8 | 5/16"-18 Hex Nut Flange Nylock |



INSTALLATION INSTRUCTIONS

Notice

Torque bolts to ANSI Specs (or OEM specs if applicable), unless otherwise stated. After the first use and at the start of each season, check torque.

Note: Make sure all hardware needed to complete this mount is in the package. Thoroughly read through and understand the instructions before installing.

Installation Instructions

1. Remove Skid Plate (A) by removing 10x torx screws (B) from the bottom of the machine. 4x towards the front, 4x in the middle, and 2x towards the rear. See **Figure 1**.
2. Once removed, align holes (C) in the Plow Mount (1) over holes (C) in the skid plate (A). Holding the mount in place, mark the U-Bolt holes (D) for drilling. See **Figure 1**.
3. With a 1/2" drill/step bit, drill holes through skid plate in the areas marked from holes (D) in Step 2. See **Figure 2**.
4. Reinstall Skid Plate (A) by resinstalling screws (B) removed in Step 1.
5. Place U-Bolts (2.1) around the tube frame, through the Skid Plate (A), and then through Plow Mount (1). Loosely secure with nuts (2.2). Be sure to place the U-Bolt underneath the brake line on the drivers side of the machine. See **Figures 3, 4, and 5**.
6. Once all hardware is started, tighten all hardware evenly.

