

ATV/UTV PolyTub Cargo Trailer

IP8001

UPC 810541022351



motoalliance

22000 Industrial Blvd, Rogers, MN 55374

www.motoalliance.com

866.527.7637

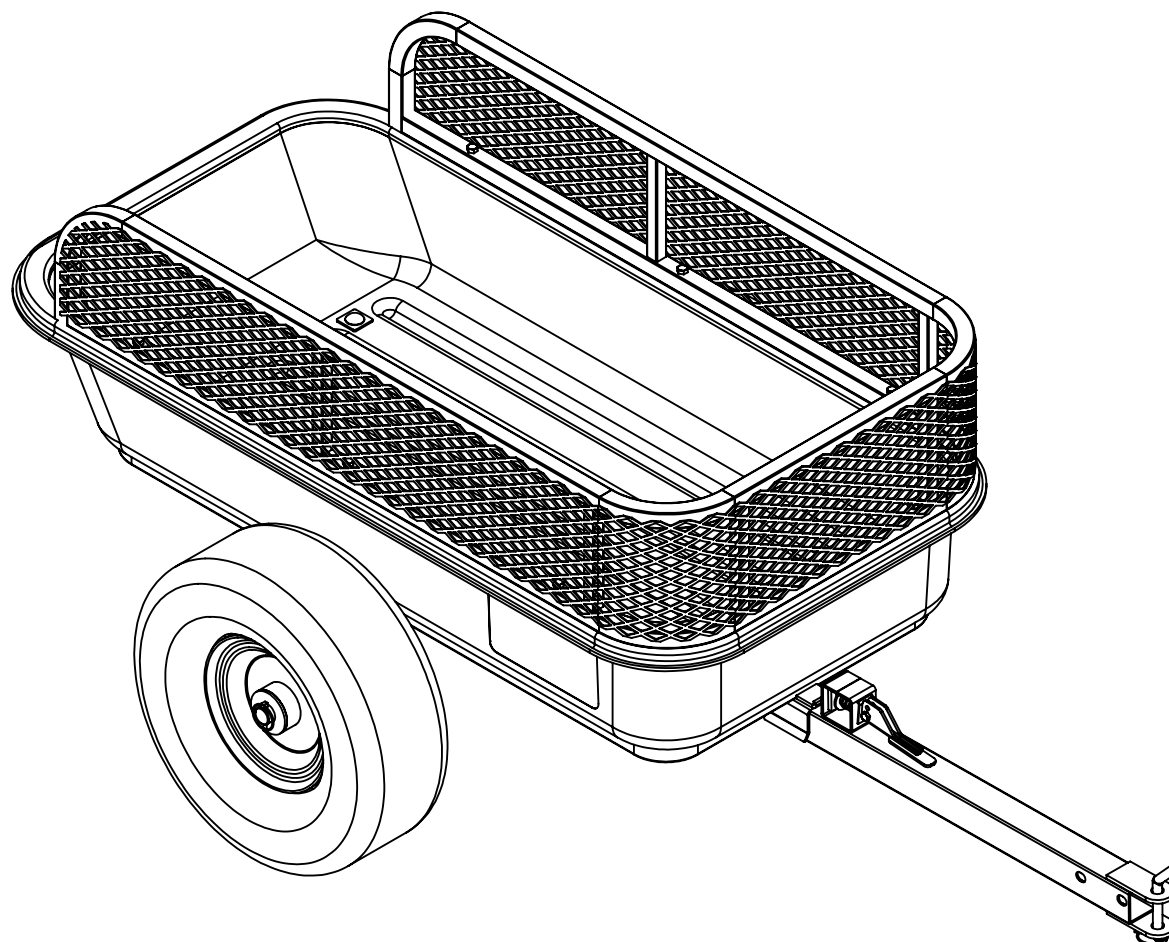

Thank you for purchasing a MotoAlliance ATV/UTV PolyTub Cargo Trailer!
Engineered in the USA, we've paid attention to all of the fine details for an easy install.
We believe you now have a trailer that will last you for years to come.
Please feel free to contact us with any questions.

Warning and User Caution

- This is a low speed, Off-Road trailer and is **not intended for road use.**
- Do not tow trailer in excess of 10mph.
- Never dump the trailer while vehicle is moving.
- Before each use, inspect trailer for damage and check that all nuts & bolts are tightened.
- Inflate tires to the correct air pressure to reduce unnecessary wear and/or damage.
- Air pressure requirements can be located on sidewall of each tire.
- Use caution when driving on uneven terrain.
- Excessive weight can cause weight shifts which can lead to loss of control of your machine and/or trailer.
- Distribute weight evenly across the trailer bed and do not exceed the hauling capacity of the trailer.
- Never haul cargo that exceeds your vehicle's towing capacity.
- Serious injury or death could result from riding in a moving trailer.
- Never allow people or animals to ride on any part of the trailer.
- Use caution near trailer tilt latch.
- Releasing the latch on a heavy load can cause the trailer to tip up abruptly and cause injury.
- Be sure latch is engaged before each use.
- When using a coupler, be sure coupler load capacity is the same or less than ball load capacity.
- Make sure hitch and trailer ball are the same size.

STEP 1- Verify all parts are accounted for.

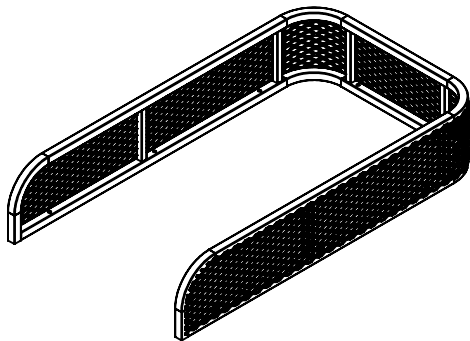

Trailer Rails (1x)

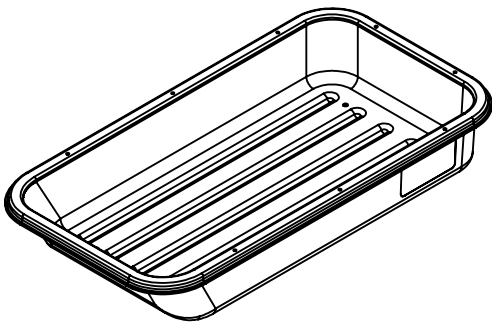

Poly Tub (1x)

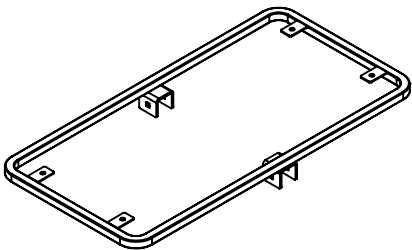

Trailer Frame (1x)

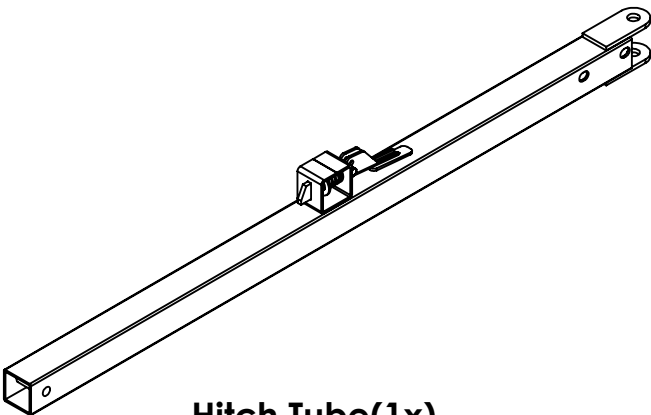

Hitch Tube(1x)

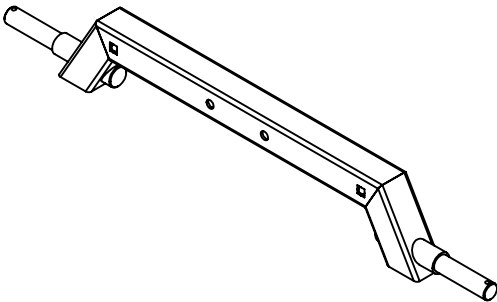

Axle (1x)

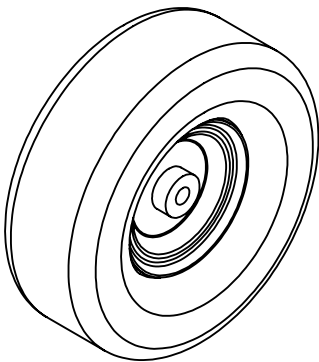

Tires (2x)

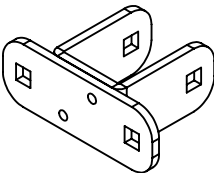

Hitch Mount (1x)

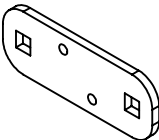

Hitch Mount Backing Plate (1x)

STEP 1- Verify all parts are accounted for.

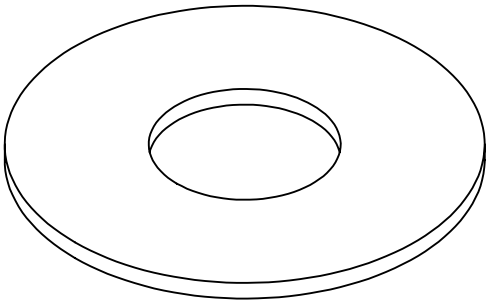

Wheel Washer (4x)

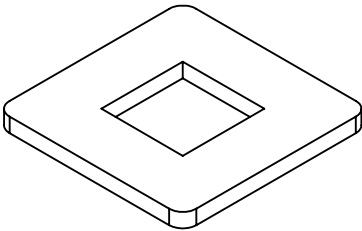

Tub Washer (4x)

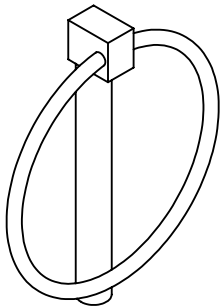

Lynch Pin (3x)

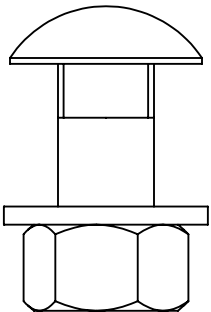

1/2" x 1.25" Hardware (4x)

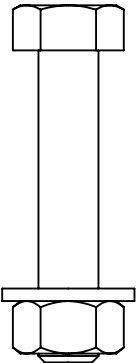

5/16" x 1.625" Hardware (8x)

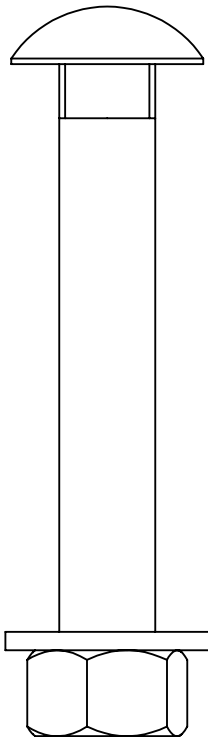

1/2" x 3.5" Hardware (5x)

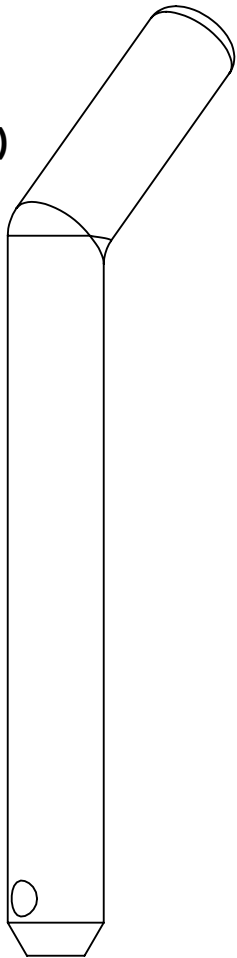

Hitch Pin (1x)

STEP 2 - Assemble Axle to Hitch Mount

-Gather the following parts:

- Axle (1x)
- Hitch Mount (1x)
- Hitch Mount Backing Plate (1x)
- 1/2" x 3.5" Hardware (2x)

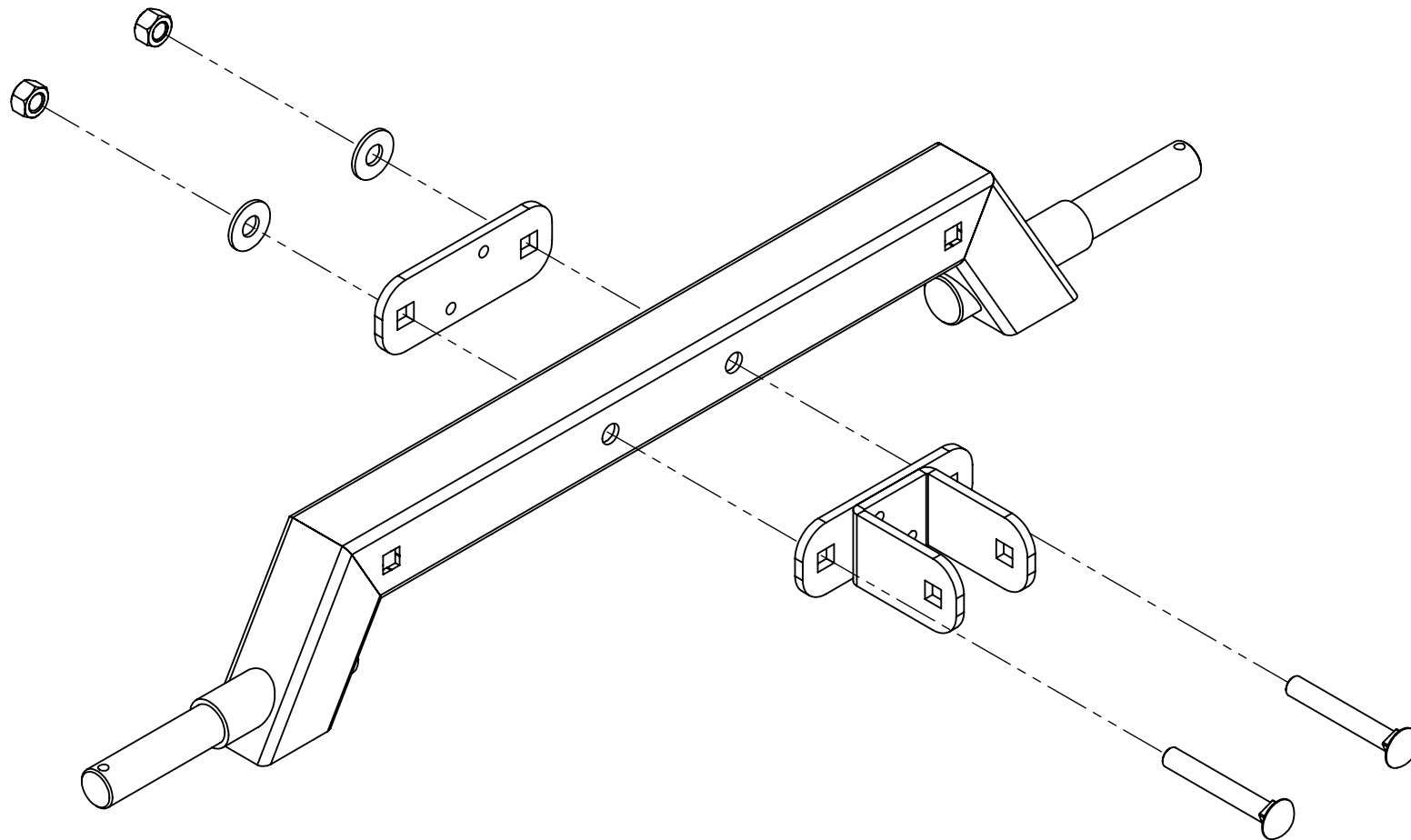

STEP 3 - Assemble Axle to Trailer Frame

-Gather the following parts:

- Axle Assembly from STEP 2 (1x)
- Trailer Frame (1x)
- 1/2" x 3.5" Hardware (2x)

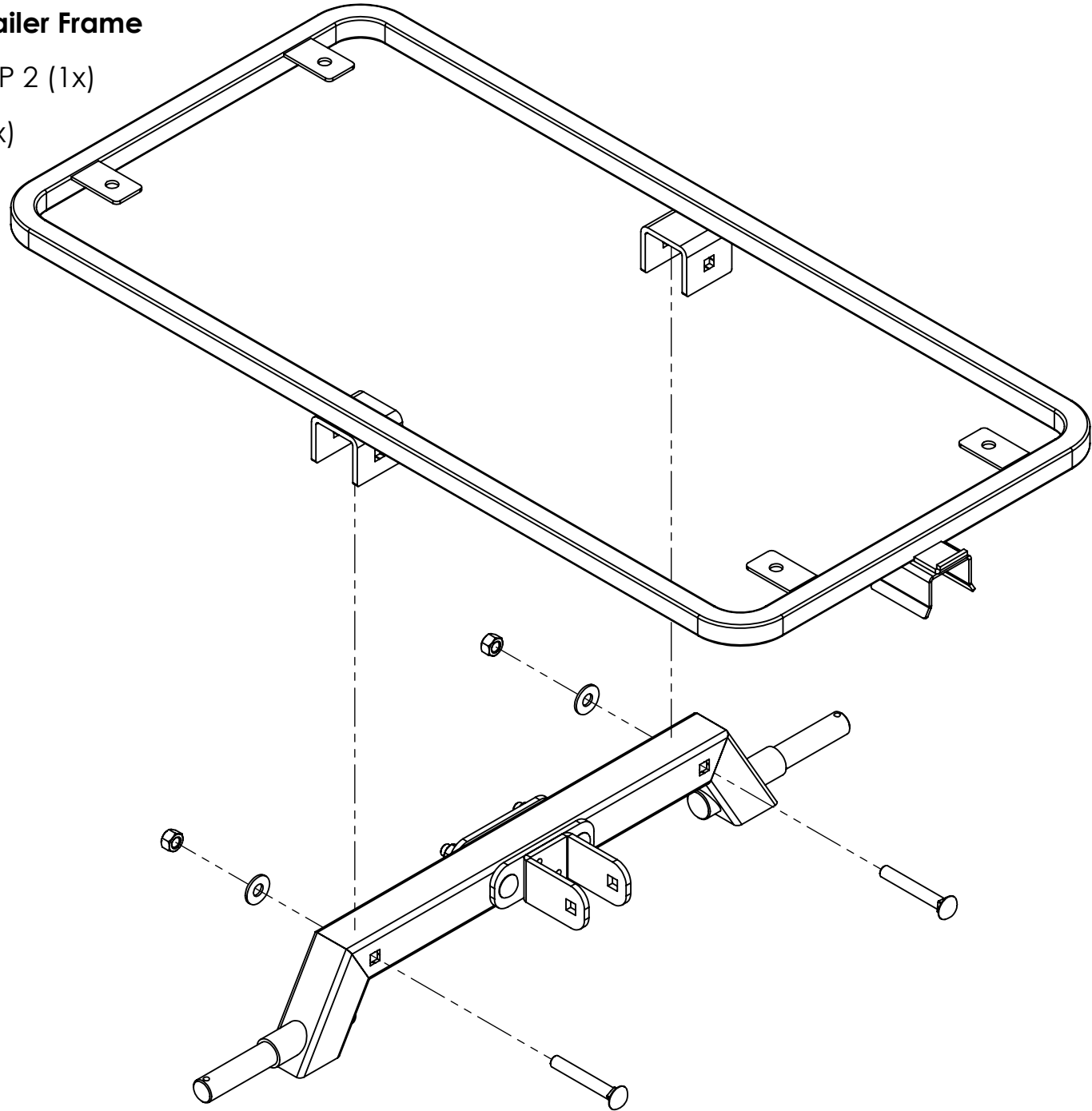

STEP 4 - Assemble Frame to Hitch Tube

- Gather the following parts:
 - Frame Assembly from STEP 3 (1x)
 - Hitch Tube (1x)
 - 1/2" x 3.5" Hardware (1x)

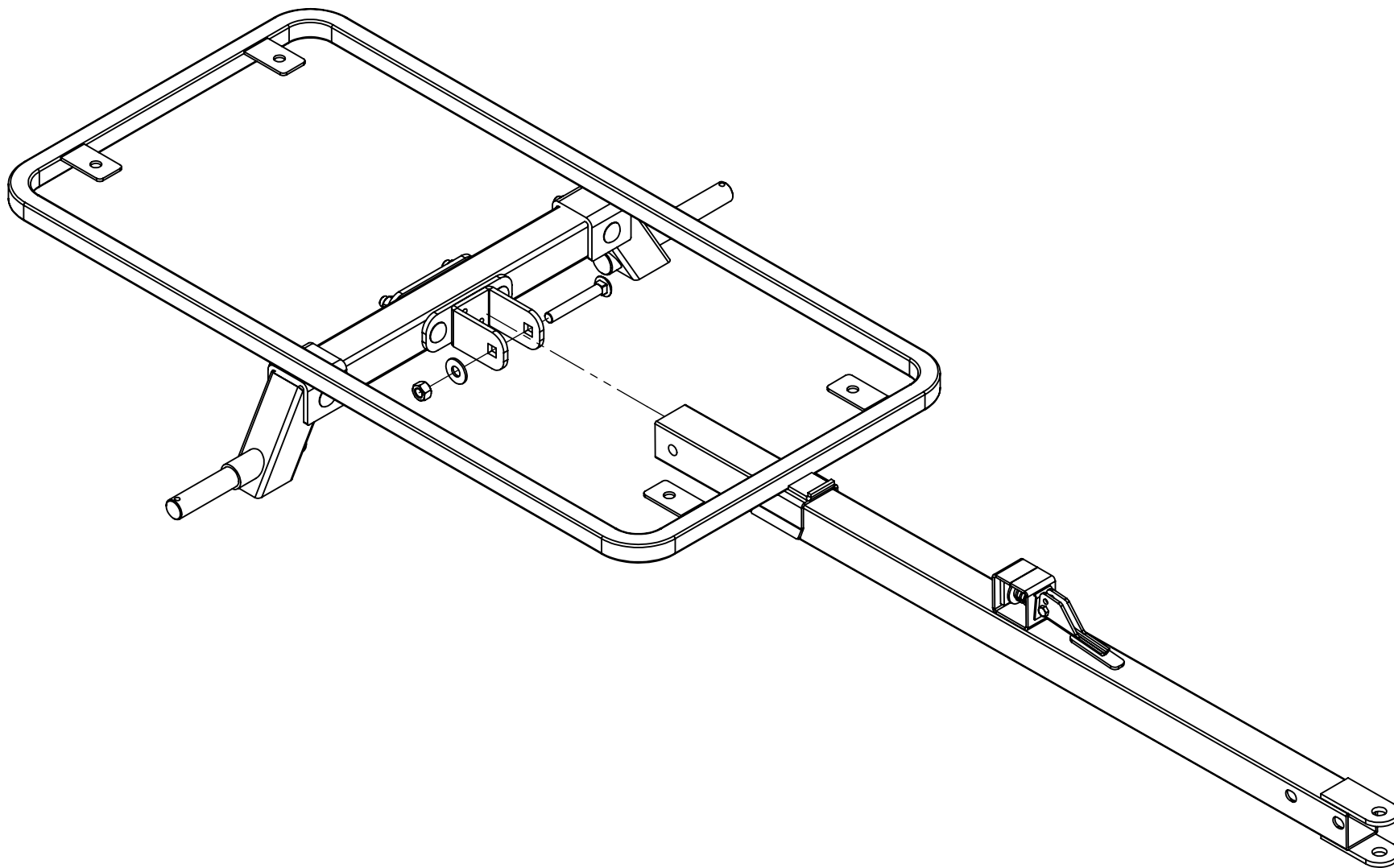

STEP 5 - Assemble Frame to Poly Tub

-Gather the following parts:

- Frame Assembly from STEP 4 (1x)
- Poly Tub (1x)
- 1/2" x 1.25" Hardware (4x)
- Tub Washer (4x)

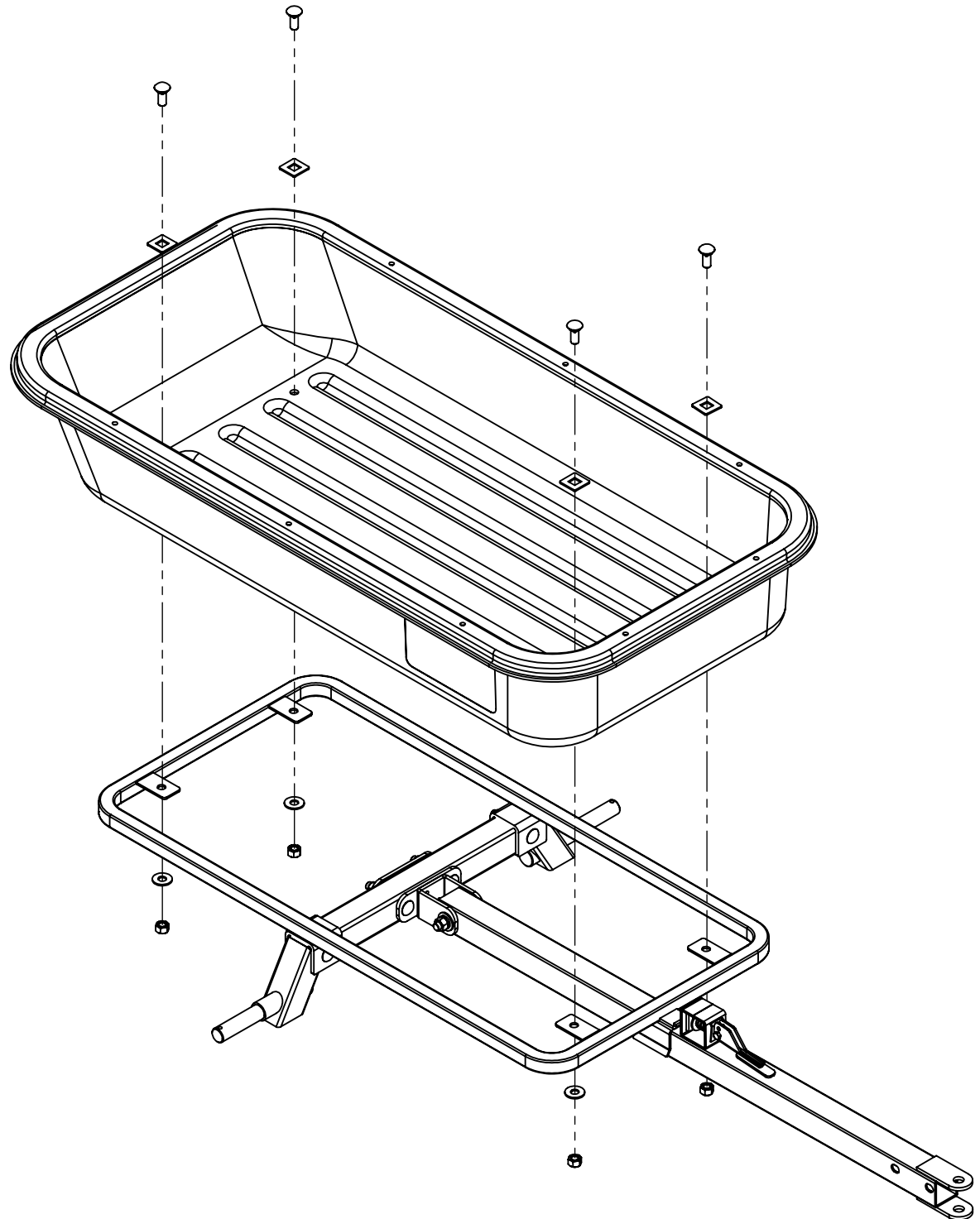

STEP 6 - Install Tires on Trailer

- Gather the following parts:
 - Trailer Assembly from STEP 5 (1x)
 - Tire (2x)
 - Wheel Washer (4x)
 - Lynch Pin (2x)

Note: Step Repeats on the Far Side

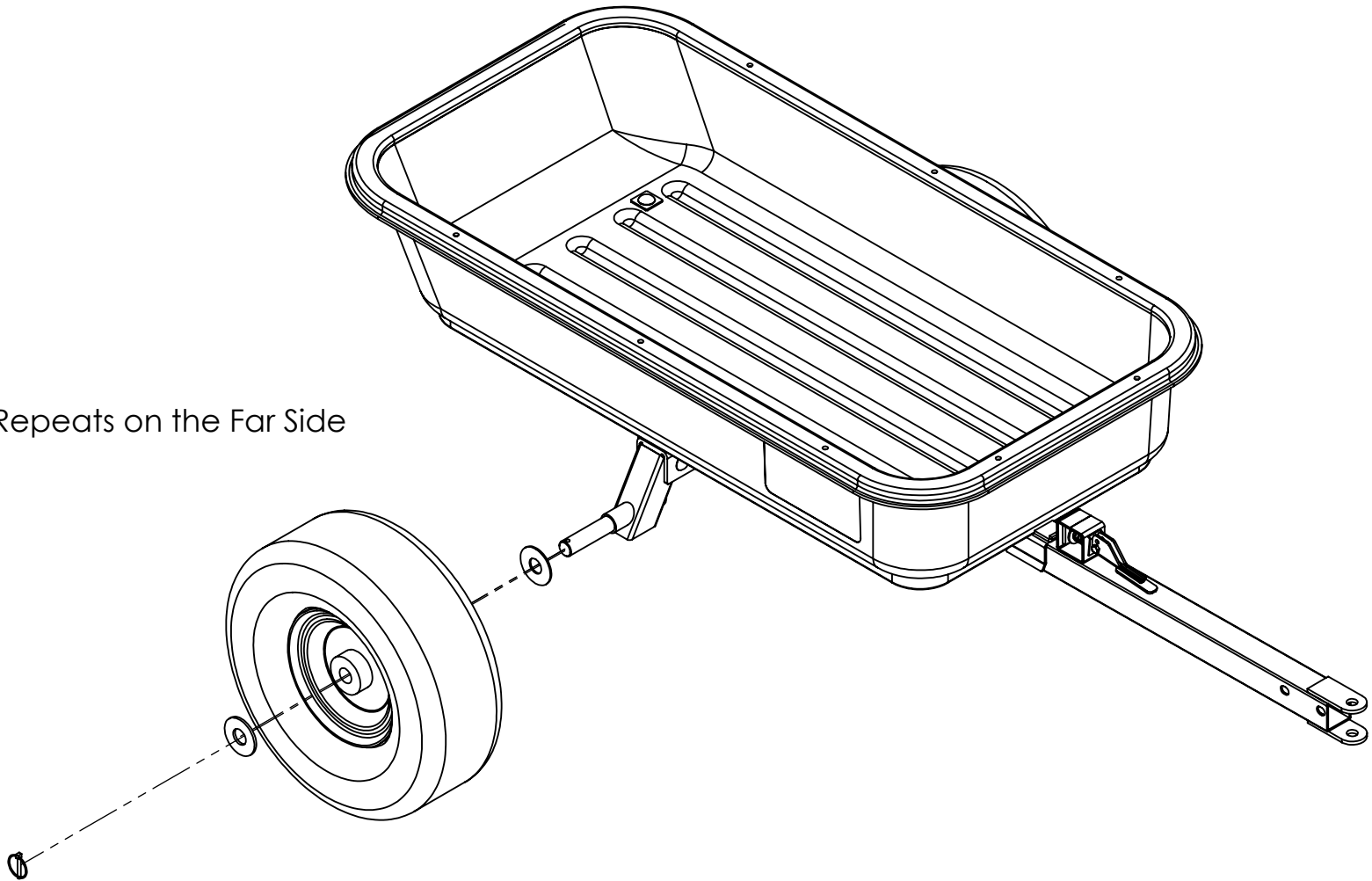

STEP 7 - Install Trailer Rails on Trailer

-Gather the following parts:

- Trailer Assembly from STEP 6 (1x)
- Trailer Rails (1x)
- 5/16" x 1.625" Hardware (8x)

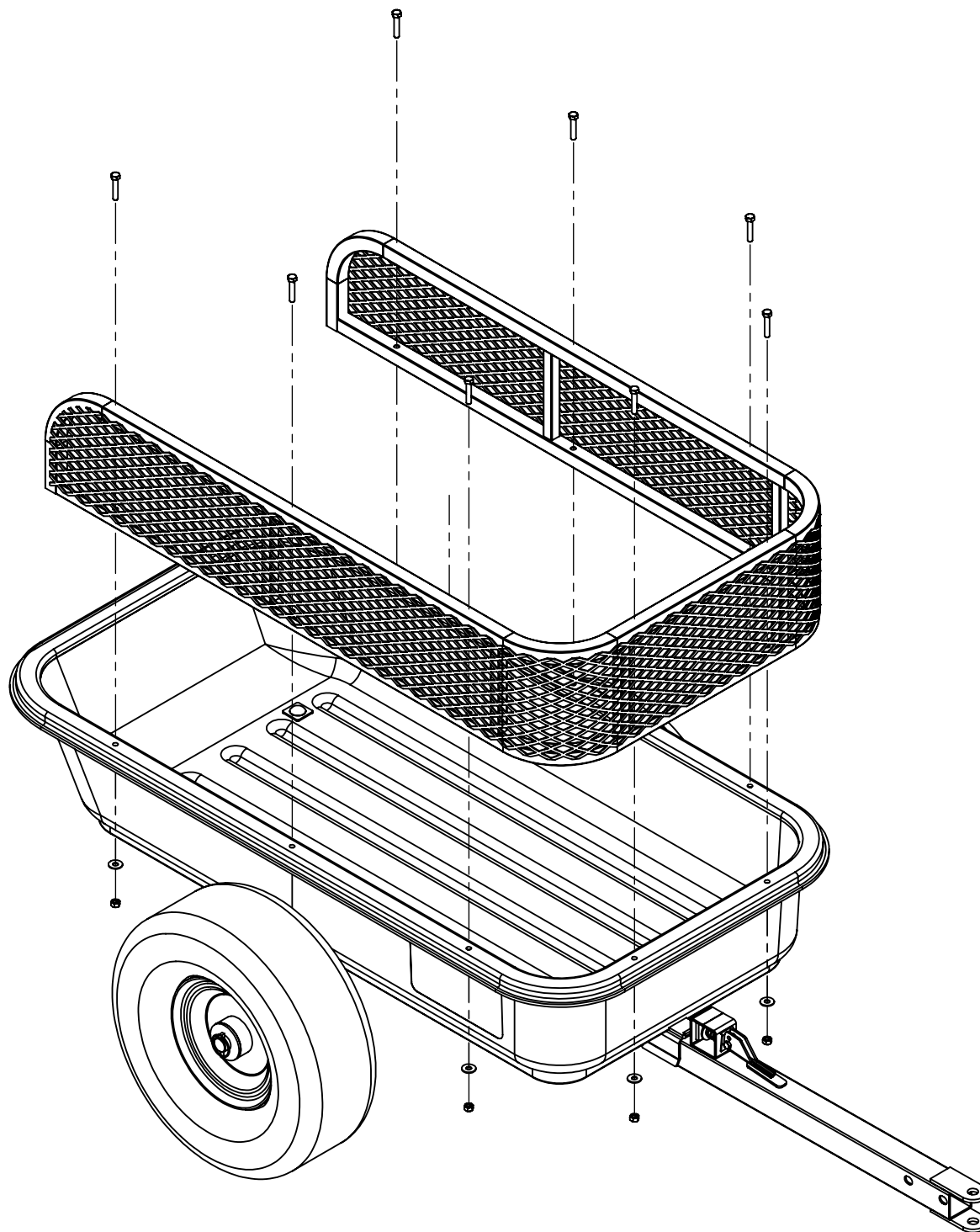

STEP 8 - Attach Trailer to Your Machine

Using the provided hardware

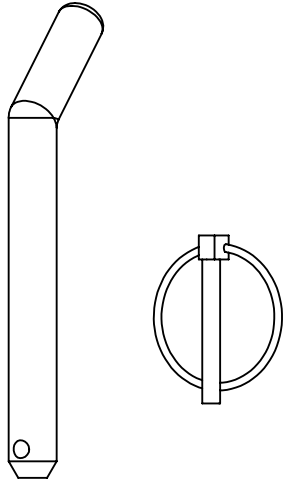

Scan this QR code to see the ball hitch coupler
online at MotoAlliance.com



Using ball hitch coupler available at Motoalliance.com

