



# K10-0621755-01 Polaris Ranger bracket lift



## INTRODUCTION

# PLEASE RETAIN THIS DOCUMENT FOR FUTURE REFERENCE

IF your ZBROZ® product has a damaged or missing part, please contact customer service directly and a new replacement part will be sent to you immediately.

For warranty issues, please return to the place of installation and contact ZBROZ®.

Business hours are Monday through Friday 8AM-5PM MST.

PHONE: (435) 753-7774

EMAIL: [customerservice@zbrozracing.com](mailto:customerservice@zbrozracing.com)

WEBSITE: [www.zbrozracing.com](http://www.zbrozracing.com)

## LIMITED LIFETIME WARRANTY

ZBROZ® will warranty to the original purchaser any failed ZBROZ® suspension product in the event of failure due to construction or material failure of the product. You will be required to contact ZBROZ® customer service with descriptions and photos that resulted in failure.

ZBROZ® builds suspension products to meet and exceed your expectations in quality, performance and durability. All ZBROZ® suspension products are rigorously tested during development and prototype parts are pushed to the limit by professional industry athletes, backcountry athletes and race teams. ZBROZ® Limited Lifetime Warranty excludes the following wear parts as these parts are considered defective when worn: Ball Joints, Bushings, Bump Stops, Tie Rod Ends, Heim Joints, Shock Absorbers Product purchased directly from ZBROZ® has a 90 day return policy on uninstalled products from the date of purchase (may be subject to restocking fee). Uninstalled product returns must be in the original ZBROZ® packaging. Please call (435) 753-7774 to get an RMA# for any return. Customer is responsible for shipping costs back to Zbroz Racing. Returns without RMA# will be refused. Contact ZBROZ® directly about any potentially defective parts prior to removal from vehicle.

ZBROZ® is NOT responsible for any subsequent damages to any related vehicle parts due to misuse, abuse, improper installation, or lack of maintenance. Furthermore, ZBROZ® reserves the right to change, modify or cancel this warranty without prior notice.

## **FOLLOW INSTRUCTIONS TO ENSURE PROPER INSTALLATION**

**READ INSTRUCTIONS THOROUGHLY AND COMPLETELY BEFORE BEGINNING INSTALLATION. INSTALLATION BY A CERTIFIED PROFESSIONAL MECHANIC IS HIGHLY RECOMMENDED. ZBROZ® IS NOT RESPONSIBLE FOR ANY DAMAGE OR FAILURE RESULTING FROM IMPROPER INSTALLATION.**



### **TOOLS:**

- 17mm End Wrench (1)
- 17mm Socket (1)
- 15mm End Wrench (1)
- 15mm Socket (1)
- Snipping Tool (1)
- Impact Drill (1)
- 13mm Socket (1)
- Vehicle Lift or Jack (1)



### **PARTS:**

- Front Bracket Lift Kit (2)  
*This part is universal and can be installed on either driver or passenger sides*
- Rear Right Hand Bracket Lift Kit (1)
- Rear Left Hand Bracket Lift Kit (1)
- 10mm-1.25 Nylock Nut (8)
- 10mm-1.25 x 60mm Hex Bolt (8)
- Sway Bar Extension Spacers (6)
- Steering Stop C Spacer (2)

## Step 1 — Safety Warning



- **MISUSE OF THIS PRODUCT COULD LEAD TO INJURY OR DEATH.** You should never operate your vehicle under the influence of alcohol or drugs. All raised vehicles have increased risk including blind spots; damage, injury and/or death can occur if these instructions are not followed.
- Suspension systems or components that enhance the on and off-road performance of your vehicle may cause it to handle differently than it did from the factory. Extreme care must be used to prevent loss of control or vehicle rollover during abrupt maneuvers.
- Always operate your vehicle at reduced speeds to ensure your ability to control your vehicle under all driving conditions. Failure to drive safely may result in serious injury or death to driver and passengers. You should never operate your vehicle under the influence of alcohol or drugs.
- Driver and passengers must **ALWAYS** wear your seat belts, avoid quick sharp turns and other sudden maneuvers. ZBROZ® does not recommend the combined use of suspension lifts, body lifts, or other lifting devices.

- Constant maintenance is required to keep your vehicle safe. Thoroughly inspect your vehicle before and after every off-road use.
- It is the responsibility of the retailer and/or the installer to review all state and local laws, with the end user of this product, related to bumper height laws and the lifting of their vehicle before the purchase and installation of any ZBROZ® products.
- It is the responsibility of the driver to check their surrounding area for obstructions, people, and animals before moving the vehicle.
- All raised vehicles have increased blind spots; damage, injury and/or death can occur if these instructions are not followed.

## Step 2 — Installation Warning



- All steps and procedures described in these instructions were performed while the vehicle was properly supported on a two post vehicle lift with safety jacks.
- Use caution during all disassembly and assembly steps to insure suspension components are not over extended causing damage to any vehicle components and parts included in this kit.

- Included instructions are guidelines only for recommended procedures and are not meant to be definitive. Installer is responsible to insure a safe and controllable vehicle after performing modifications.
- ZBROZ® recommends the use of an OE Service Manual for model/year of vehicle when disassembly and assembly of factory and related components.
- Unless otherwise specified, tighten all bolts and fasteners to standard torque specifications listed within the OE Service Manual.
- Suspension components that use rubber or urethane bushings should be tightened with the vehicle at normal ride height. This will prevent premature wear or failure of the bushing and maintain ride comfort.
- Larger tire and wheel combinations may increase leverage on suspension, steering, and related components.
- Due to payload options and initial ride height variances, the amount of lift is a base figure. Final ride height dimensions may vary in accordance to original vehicle ride height. Always measure the vehicle ride height prior to beginning installation.

**Step 3 — Installation Warning Cont.**

- The following bracket lift kit can be installed with shocks on your "VEHICLE" by using a floor jack or lift. Select a flat install location. If using floor jack, always make sure to block tires - work safely!
- Lift Ranger using a floor jack or lift and remove all nessessary tires.

## Step 4 — Front Bracket Kit Installation



- Start by loosening the top bolt on the sway bar link rod pivoting mounting blocks that hold the sway bar to the frame using a 15mm Ratchet or End Wrench. This is located at the pivoting mounting blocks that hold the sway bar to the frame. Pull the top portion of the sway bar off and set it aside for later. (IMAGE 1)
- **Note:** you will need to loosen and remove the top portion of the sway bar on both driver and passenger sides of the vehicle in order to swing it up out of the way.
- Once the sway bar is out of the way remove the lower bushing so that the link rod has nothing on it. (IMAGE 2)
- Take one of the supplied spacers and slide it onto the link rod first followed by the factory bushing. (Image 3)
- **NOTE:** Some Polaris Ranger models do not have a front sway bar or if you are choosing to remove the sway bar completely then you may skip this step.

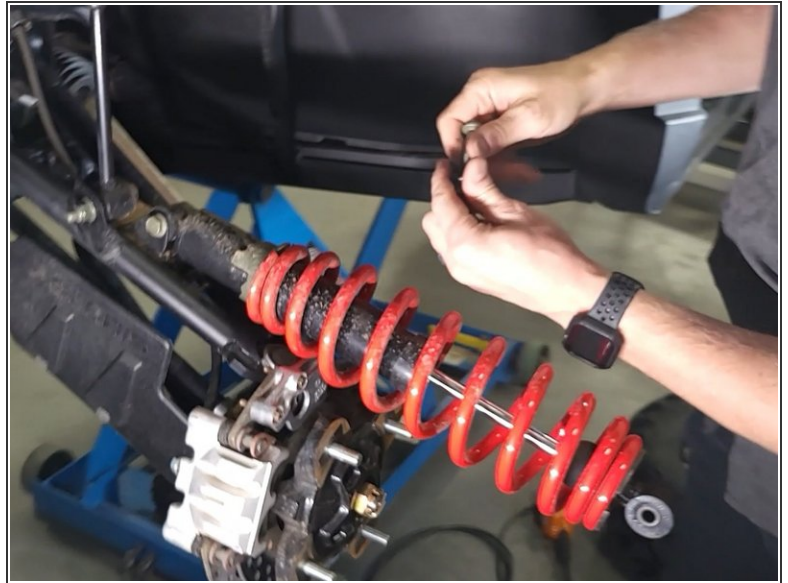
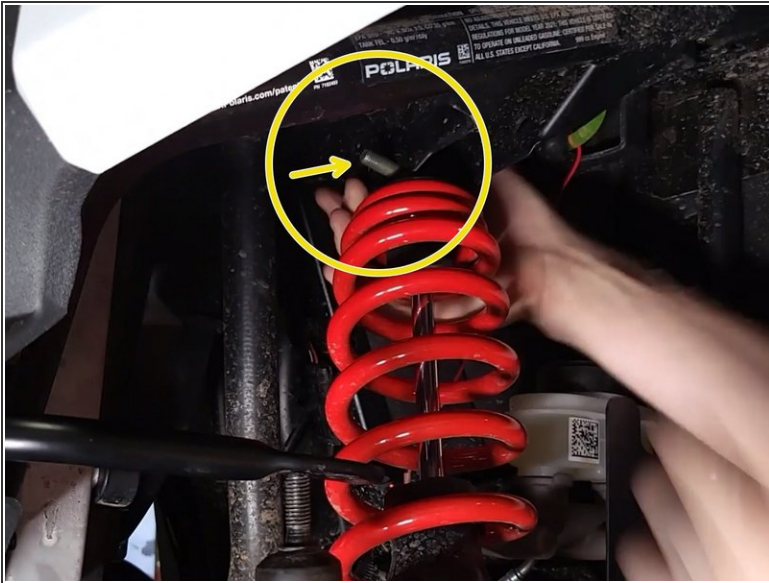

**Step 5**

- Using a 15mm End Wrench and 15mm Socket, loosen and remove the upper shock bolt.
- Swing the shock down out of the way so that you have room to install the front ZBROZ bracket Kit.

## Step 6

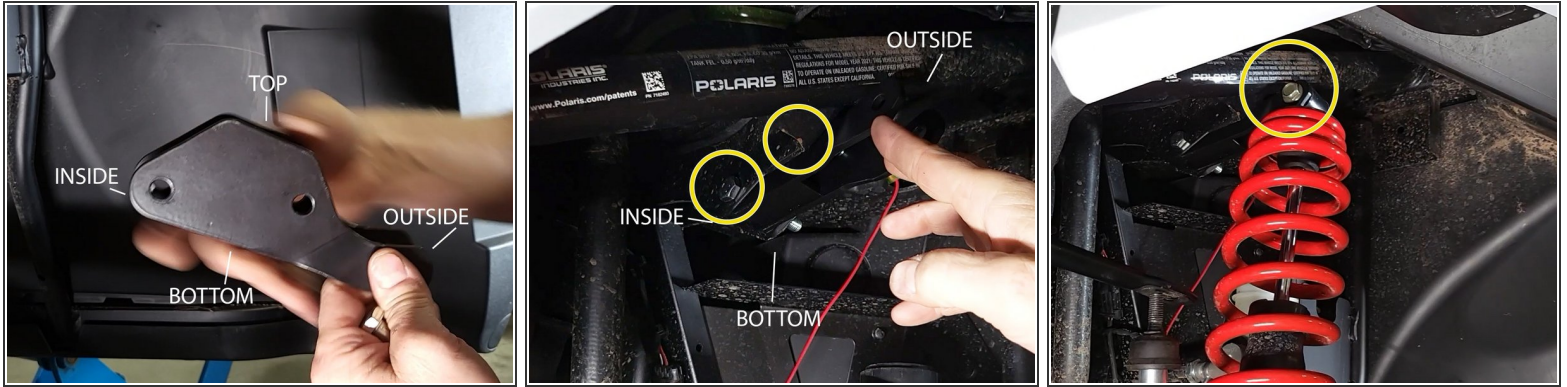

- The ZBROZ Front bracket kits are universal and can be installed on either side of the vehicle. There is no right or left specific kit. The Front Bracket is all in one piece. (IMAGE 1)
- Mount the front bracket by lining up bracket bolt holes with the factory shock mounting holes. There will be two bolt locations highlighted with yellow circles. The second hole is hidden, you will have to reach and feel where it is. (IMAGE 2)
- Torque bolts to factory specs.
- Now, rotate your shock back up and slide it into the outside mounting location. Place the factory bolt back through the mounting holes and shock eyelet so that it holds the shock in place. (IMAGE 3)
  - Torque shock bolt to factory specs.
  - REPEAT STEPS 4 - 8 on the other side of the vehicle.

## Step 7

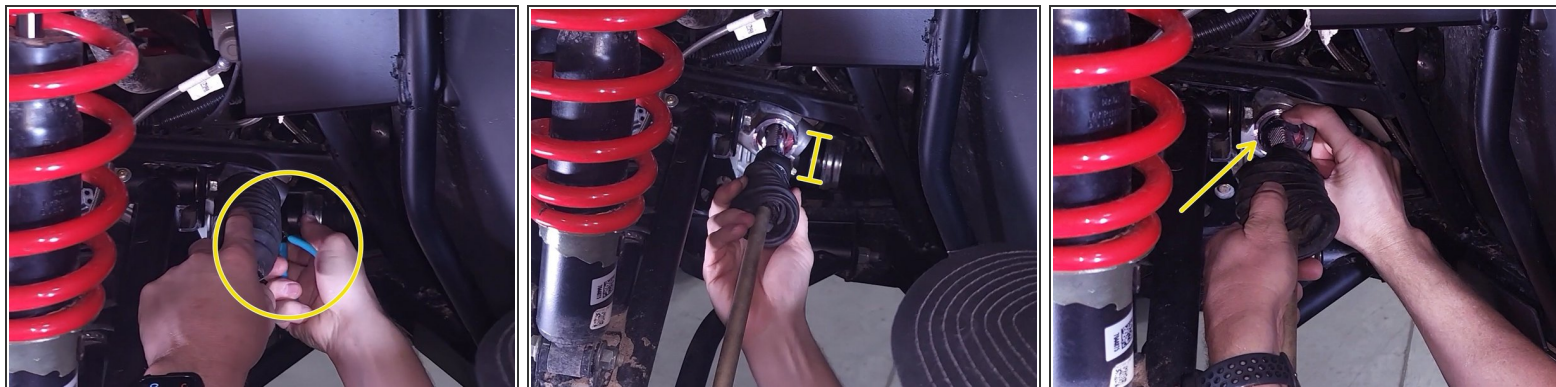

- Using snips, reach back behind the steering rack boot and clip the factory placed zip-tie so that you can pull the boot back to expose the tie rod end.
  - Now that the tie rod end is exposed, take pliers and grip the Steering Stop Spacer on the opposite side as the gap. Push the spacer onto the steering shaft so that it rests around it.
  - Slide the boot back over the tie rod end and secure it with a zip-tie.
- (i) NOTE:** Repeat steps on both sides.

## Step 8 — Rear Bracket Kit Installation



- Start by completely removing the factory sway bar link rod using a 15mm Ratchet or End Wrench. You will need to unbolt both the top and bottom link rod bolts. (IMAGE 1 & 2)
- Note: you will need to loosen and remove the top portion of the sway bar on both driver and passenger sides of the vehicle in order to swing the sway bar up out of the way.
- Once the sway bar is removed, insert the two supplied spacers on both sides of the link rod followed by the factory bushings. (IMAGE 3)

## Step 9

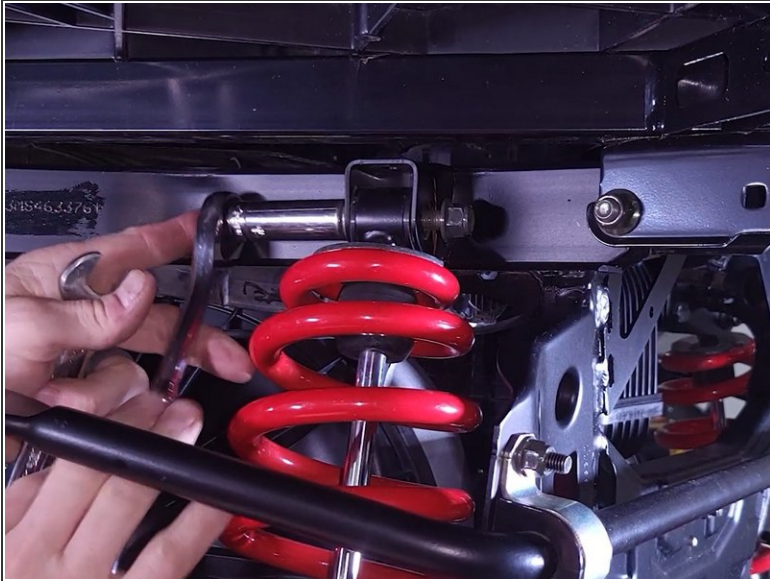

- Now, reinstall the link rod with spacers. When installing the rear lower sway bar link to the a-arm, you must tighten this nut all the way. When you swing the sway bar link up for top mounting you cannot get to the bottom nut.
- You will only bolt the bottom side of the link rod at this time.

**Step 10**

- Using a 15mm Socket and End Wrench, loosen the top shock and remove the bolt.
- Push the top of the shock down and out of the way so that you can install the rear bracket kit.

## Step 11

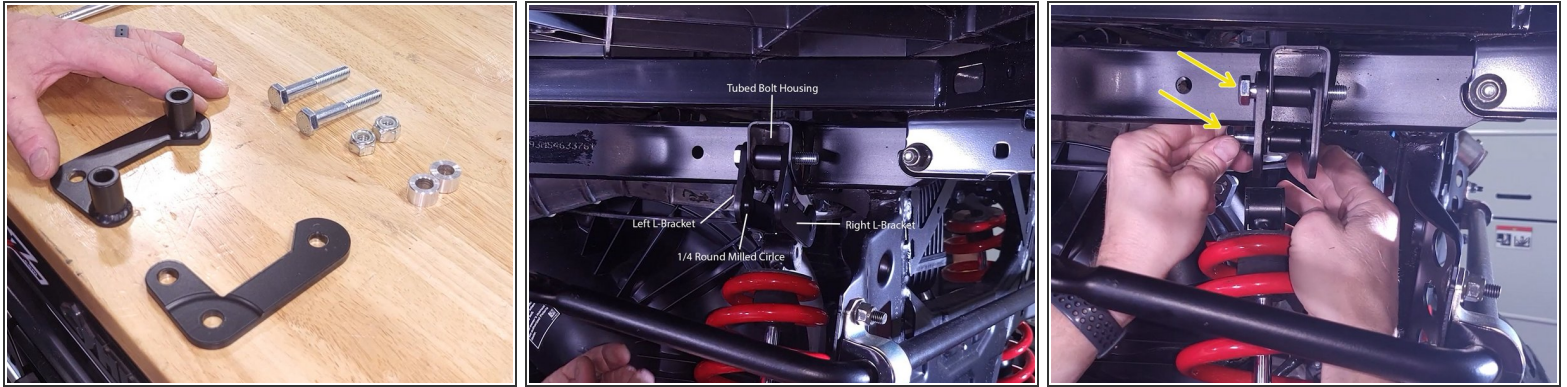

- Locate one of the rear bracket kits and hardware, it should be in two separate pieces. as shown in IMAGE 1
- Slide the right L bracket with the bolt tube housing inside the shock mounting location. The bolt tube housing should be facing towards the front of the Ranger. (IMAGE 2)
- Now place the left L-bracket with the 1/4 round milled circle on the left, outside of the shock mounting location. (IMAGE 2)
- Slide the supplied 17mm bolt through the L-Brackets and front shock mounting holes. Do this for the backside bracket locations using the supplied 17mm bolt and nut. (IMAGE 3)
- Torque both bolts to factory specs.

## Step 12

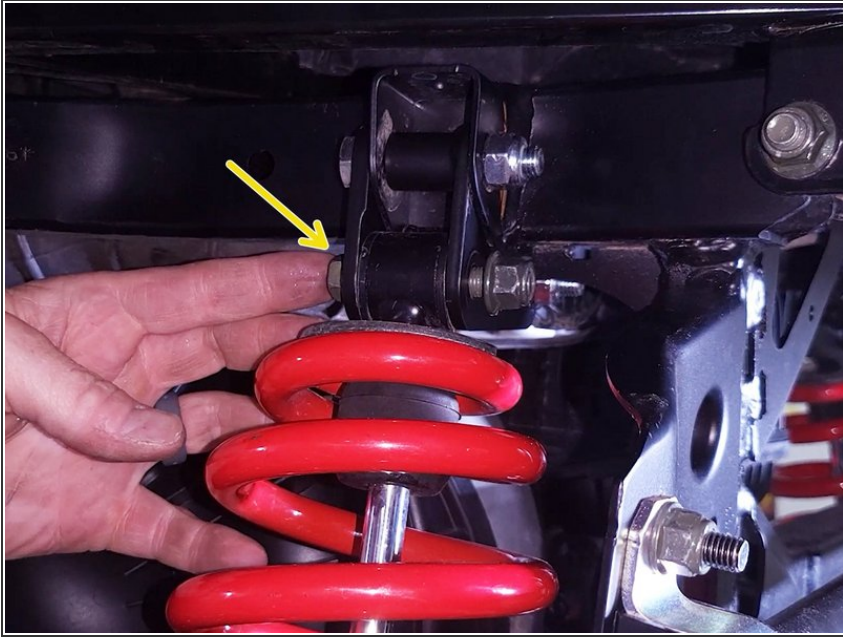

- Lift up on the rear hub and arm to slide the top of the shock into the newly installed Bracket Kit housing. Using the factory bolt and nut, secure the shock to the Bracket Kit.
- Go back and torque all three bolts to factory specs.

## Step 13

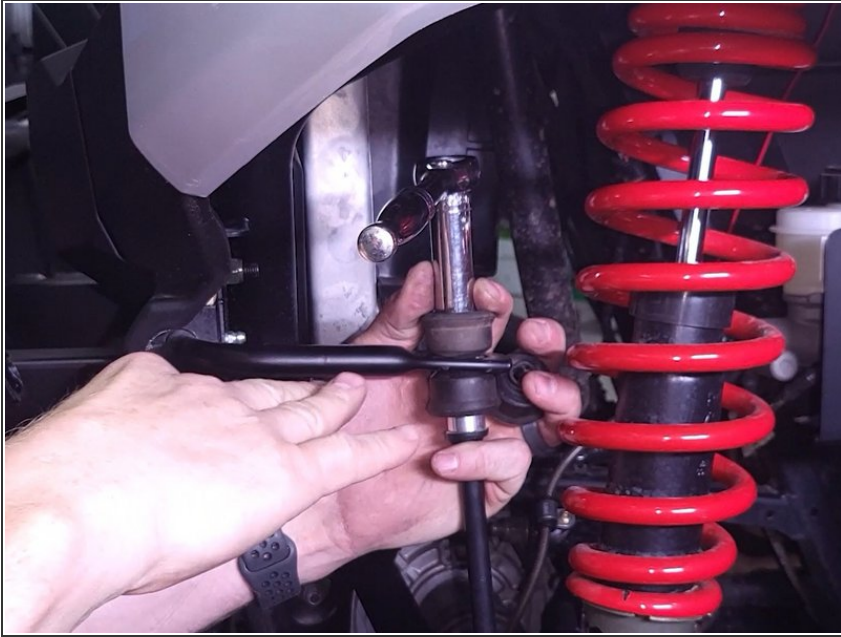

- Now that both the front and rear Bracket Kits are installed, we need to go back and reconnect the Sway Bars to the Link Rods.
- NOTE: The best way to do this is to reinstall the vehicle wheels and then lower the vehicle to the ground unsupported by a lift or jack. This will raise the link rod up through the sway bar mounting hole giving you more room to bolt the top bushing back onto the link rod.
- You can now reinstall the front sway bar link rod top bushings and torque to factory specs. Make sure to do this on both sides of the vehicle.
- The rear sway bar link rods require a few more steps. proceed to step 16.

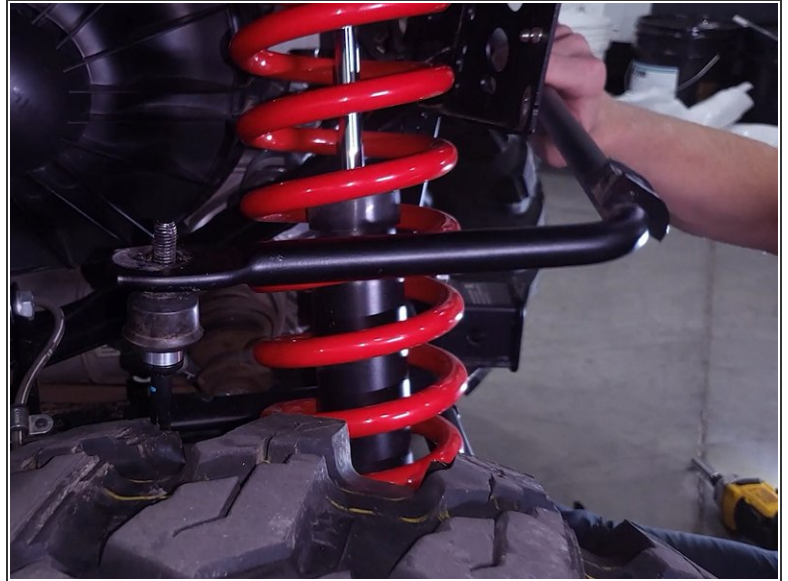
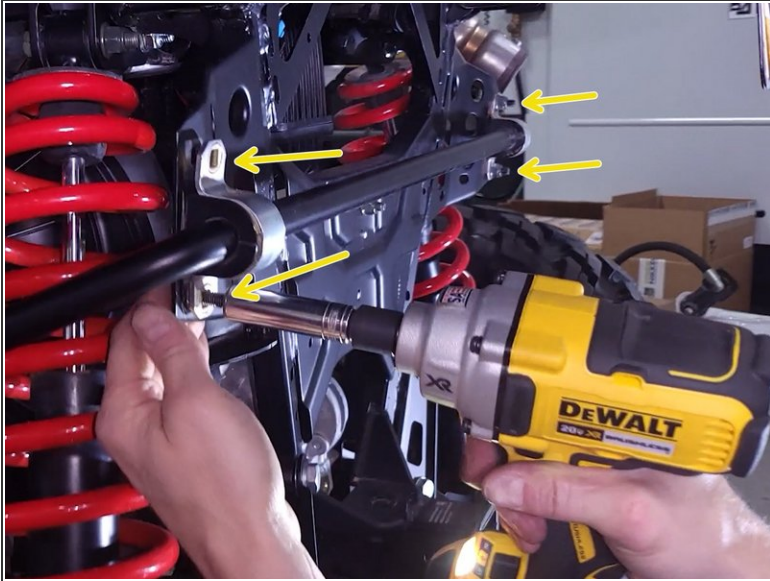

**Step 14**

- To reinstall the rear sway bar to the link rods, it is best to remove the rear sway bar mounting brackets on both sides of the vehicle. This will allow you to lower the sway bar to a horizontal flat position.
- Because these are carriage bolts it is best to use a 13mm socket and impact drill to remove the 4 bracket bolts.

## Step 15

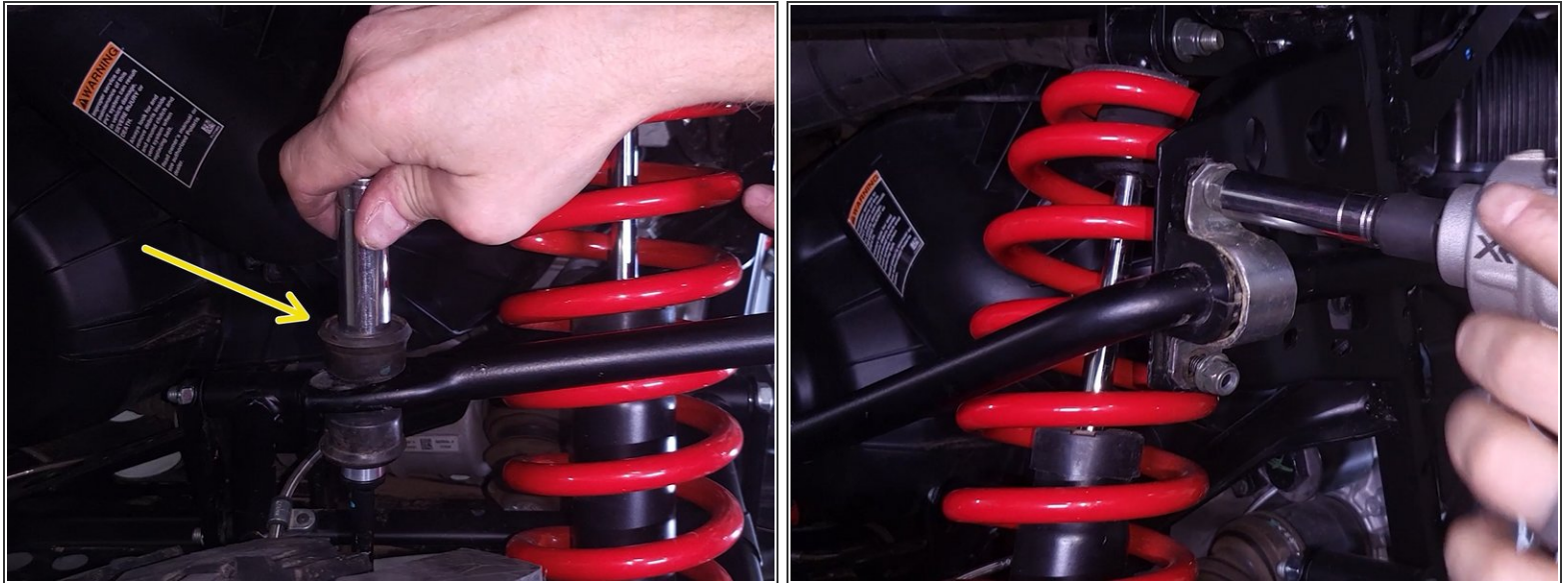

- Now place the top link rod bushing and bolt back on and hand tighten so that the link rod stays in place while you install the other side of the vehicle.
- Place the rear sway bar mount brackets back on and lift the sway bar back into place to reinstall the carriage bolts. NOTE: You may need assistance from an additional person to help lift the sway bar back into position as you insert the bolts and nuts.
- This would be a good time to add additional grease to your rear mounting brackets to prevent squeaks.

## Step 16 — Installation Complete!



- Your Bracket Lift Kit installation is complete, please make sure to go back and check all bolts and nuts at installation points.

## Step 17 — Vehicle Handling Warning



- Increasing the height of your vehicle raises the center of gravity and can affect stability and control. Use caution on turns and when making steering corrections.
- Vehicles with larger tires and wheels will handle differently than stock vehicles. Take time to familiarize yourself with the handling of your vehicle.

## Step 18 — Wheel Alignment, Headlight, and Safety/Security Systems Adjustment



- It is necessary to have a proper and professional wheel alignment performed by a certified alignment technician. Align the vehicle to factory specifications. It is recommended that your vehicle alignment be checked after any off-road driving.
- In addition to your vehicle alignment, for your safety and others, it is necessary to check and adjust your vehicle headlamps for proper aim and alignment.
- If the vehicle is equipped with active or passive safety/collision monitoring and/or avoidance systems including, but not limited to, camera- or radar-based systems, check and adjust your vehicle's systems for proper aim and function.

By installing this product, you acknowledge that the suspension of this vehicle has been modified. As a result, this vehicle may handle differently than that of factory-equipped vehicles. As with any vehicle, extreme care must be used to prevent loss of control or roll-over during sharp turns or abrupt maneuvers. Always wear seat belts, and drive safely, recognizing that reduced speeds and specialized driving techniques may be required. Failure to drive this vehicle safely may result in serious injury or death. Do not drive this vehicle unless you are familiar with its unique handling characteristics and are confident of your ability to maintain control under all driving conditions. Some modifications (and combinations of modifications) are not recommended and may not be permitted in your state. Consult your owner's manual, the instructions accompanying this product, and state laws before undertaking these modifications. You are responsible for the legality and safety of the vehicle you modify using these components.