

# CAN-AM DEFENDER

PLOW MOUNT

PART #105780 Rev F

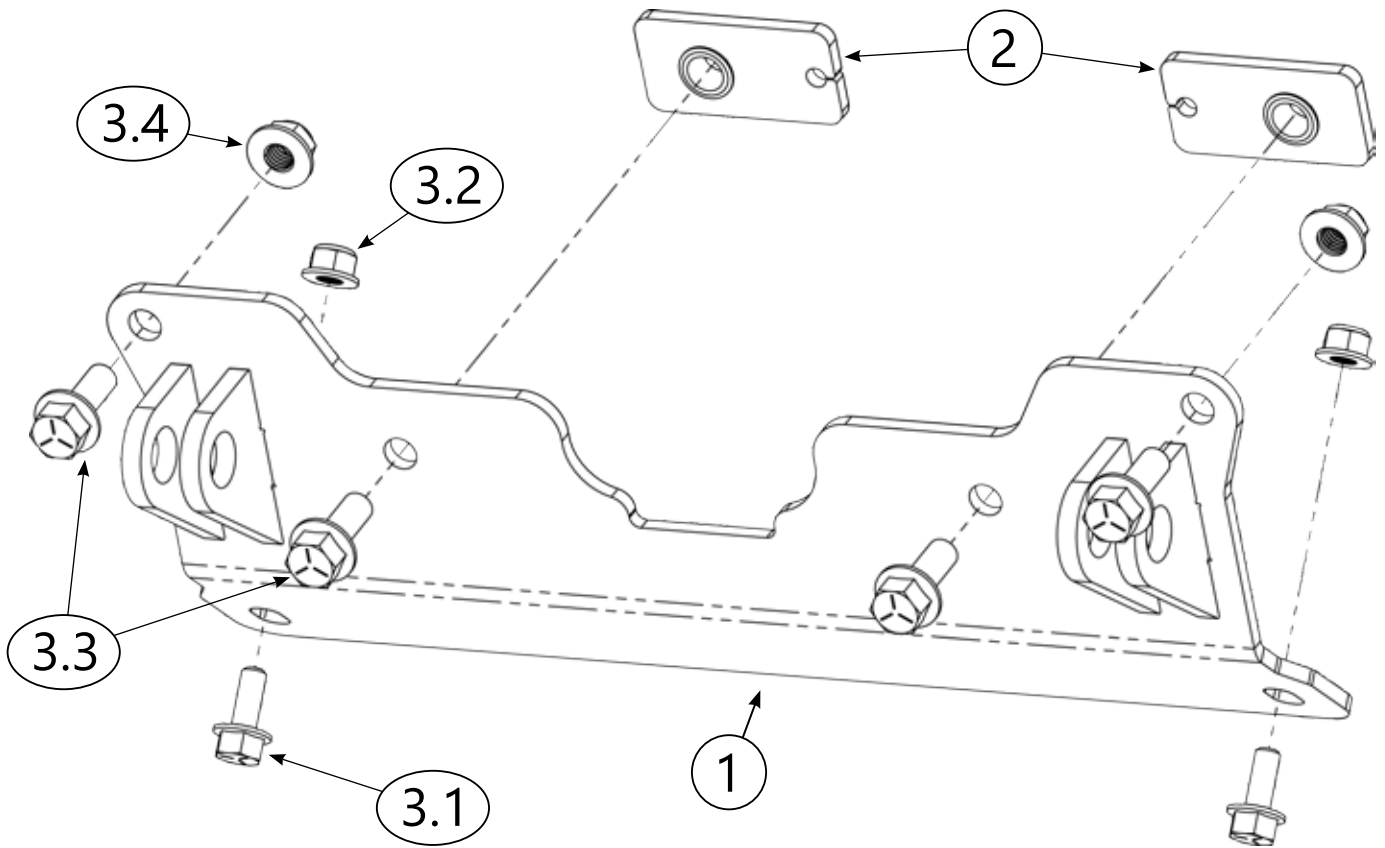

Item #	Qty.	Description
1	1	Plow Mount Plate
2	2	Plow Mount Nut Plate
3	1	Hardware Kit (HK-162)

Item #	Qty.	Description
3.1	2	5/16"-18 x 0.75" Hex Flange Bolt
3.2	2	5/16"-18 Hex Flange Nylock Nut
3.3	4	3/8"-16 x 1.00" Hex Flange Bolt
3.4	2	3/8"-16 Hex Flange Nylock Nut



# INSTALLATION INSTRUCTIONS

**Note:** Make sure all hardware needed to complete this mount is in the package. Thoroughly read through and understand the instructions before installing.

1. Locate the two holes (A) on the bottom frame. Attach the Plow Mount Plate (1) to the frame by inserting the two 5/16" bolts (3.1) through the mount and up into the frame. Assemble with the 5/16" nuts (3.2) (**DO NOT TIGHTEN AT THIS TIME**)
2. Insert Plow Mount Nut Plates (2) into holes (B) behind the stock bumper as shown in **Figures 1 and 2**. Align the Mount Plate and the Nut Plates, then install the 3/8" bolts (3.3). (**TIGHTEN DOWN ALL NUTS AND BOLTS AT THIS TIME**)
3. In order to install the remaining bolts, drilling is required. Using a 13/32" drill bit, drill through the bumper. Make sure to use the Plow Mount bolt hole as the template (C). Repeat on opposite side of plow mount. See **Figure 3**.
4. Once holes are drilled, install remaining 3/8" bolts (3.3) and 3/8" nuts (3.4). See **Figure 4**.
5. Tighten all hardware evenly.

