

MAVERICK X3

Rear Receiver PART # 101580

Kit Components:

Item #	Qty.	Description
1	1	Receiver Plate

INSTALLATION INSTRUCTIONS:

1. Find a jack to raise the rear end of the machine and take the pressure off the trailing arm linkages.
2. Remove the six nuts (A) on rear plate as shown in Figure 2. Plate will come off. Keep all hardware as it will be reused.
3. Place receiver plate over bolts and linkages, reinstall using nuts removed in Step 2 as shown in Figure 3. Tighten bolts and nuts to 33 ft. lbs. (45Nm).

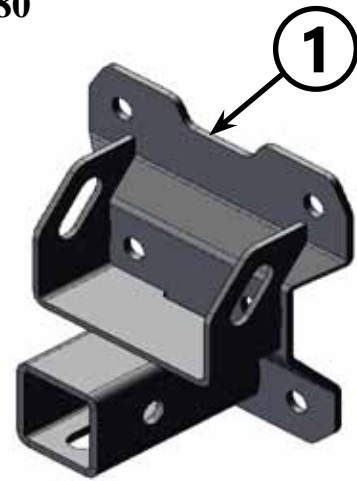

“Figure 1”

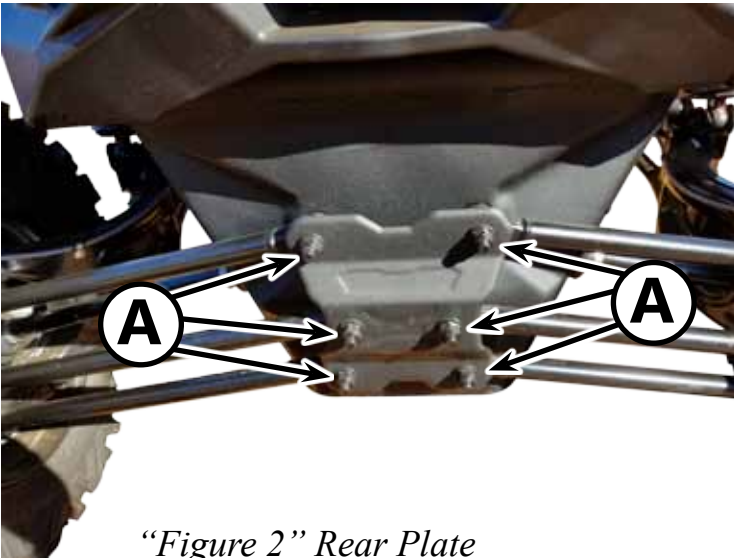

“Figure 2” Rear Plate



“Figure 3” Receiver Install

