

HONDA TALON PLOW MOUNT

Plow Mount

Part # 106075

Kit Components:		
Item #	Qty.	Description
1	1	Plow Mount Backer Plate
2	1	Plow Mount Mounting Plate
3	1	Front Bolt Plate
4	1	Rear Bolt Plate
5	1	HK-363
5.1	4	3/8"-16 x .88" Hex Flange Bolt
5.2	4	3/8"-16 x 1.25" Hex Flange Bolt
5.3	2	M8-1.25 x 25 Hex Flange Bolt

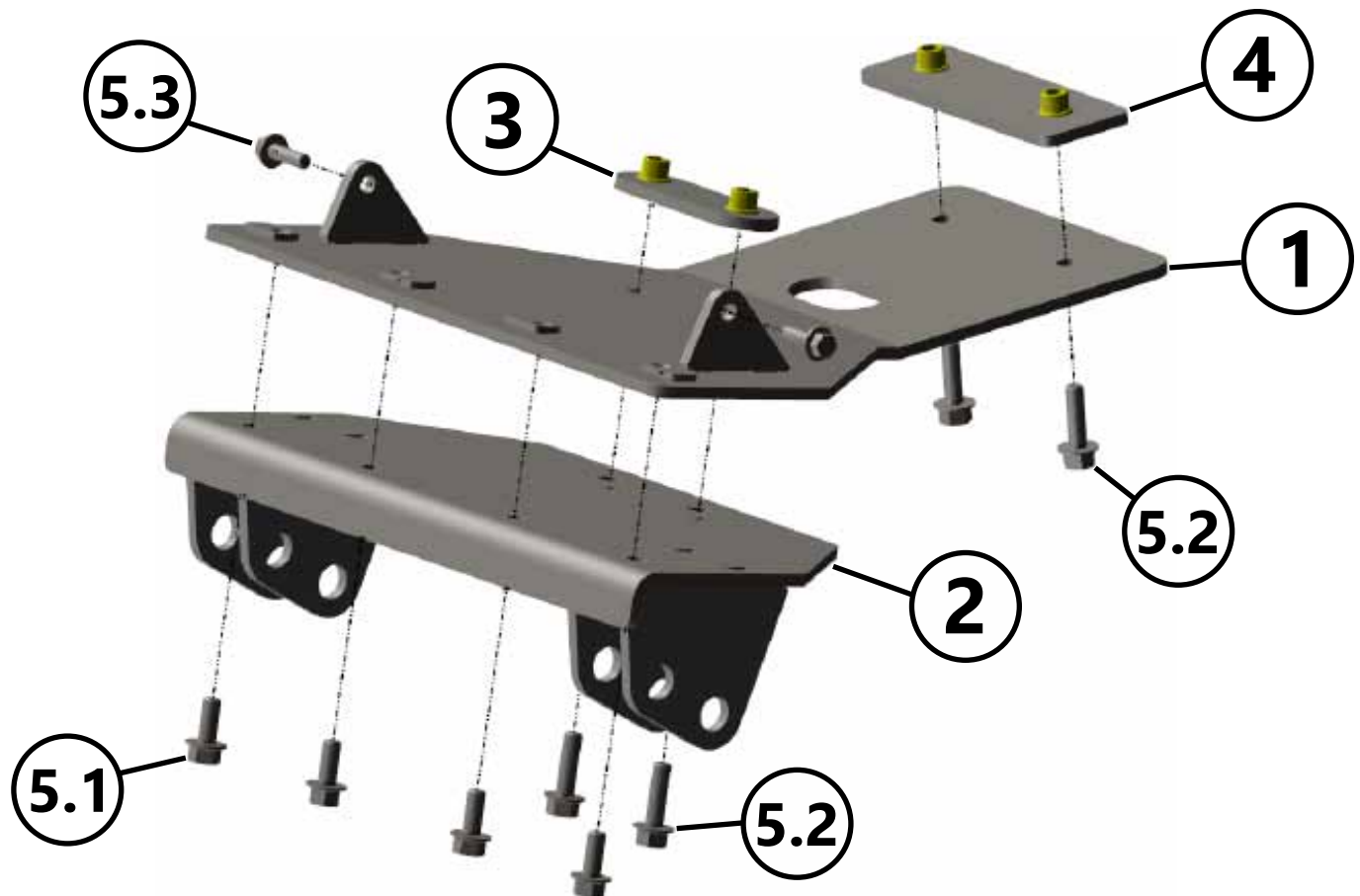

INSTALLATION INSTRUCTIONS:

Note: Before starting, be sure that all of the correct hardware that is needed to complete this mount is in the package. Thoroughly read through and understand the instructions before installing.

1. Set Bolt Plate (3&4) in place on the top side of the skid plate of the machine as shown in **Figure 1**.

Note: The bolt holes on the bolt plate will not be centered with the holes in the skid plate when the Backer Plate (1) is installed in a later step. This is to keep from the plow mount from sliding back when in use.

2. Hold Backer Plate (1) in place and secure to only the back bolt plate (4) using the longer 3/8" bolts (5.2) as shown in **Figure 2**. Secure the upright tab of the backer plate (1) to the bumper using M8 bolts (5.3) as shown in **Figure 3**. **Note:** Do not tighten at this time
3. Hold Mounting Plate (2) in place. Secure to Backer Plate (1) using the shorter 3/8" Bolts (5.1) and to the Front Bolt Plate (3) using the longer 3/8" Bolts (5.2) as shown in **Figure 4**.
4. Tighten all hardware evenly.

OFF SEASON USE:

Note: Plow Mount Plate (2) can be removed during the off season or while the plow is not in use. Plow mount backer plate (1) will remain on the vehicle and act as a skid plate for the machine.

1. Remove bolts (5.1 & 5.2) shown in **Figure 4** and set plow mount plate (2) off to the side as it will no longer be used.
2. Once plow mount plate is removed, reinstall bolts (5.2) into the front bolt plate (3) and bolts (5.1) into the backer plate (1) to keep the threads from getting damaged. **Note:** Putting anti-seize on the bolts will help keep them from rusting making it easier to remove the mount plate.

Figure 1

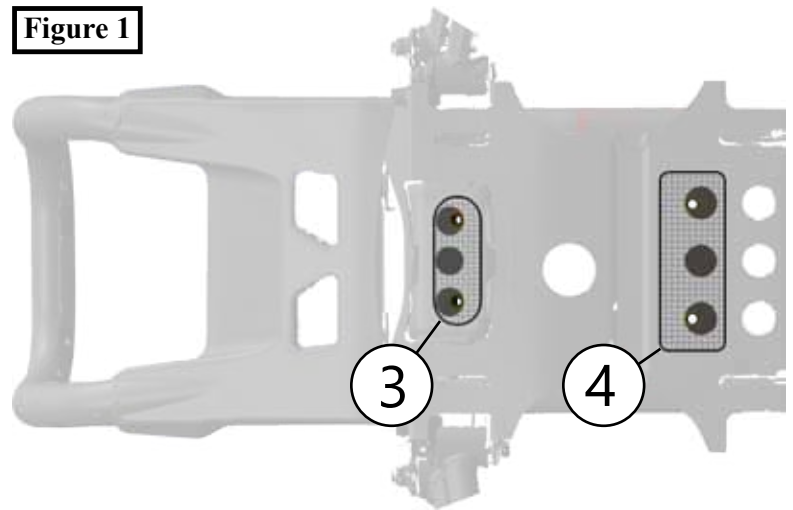

Figure 2

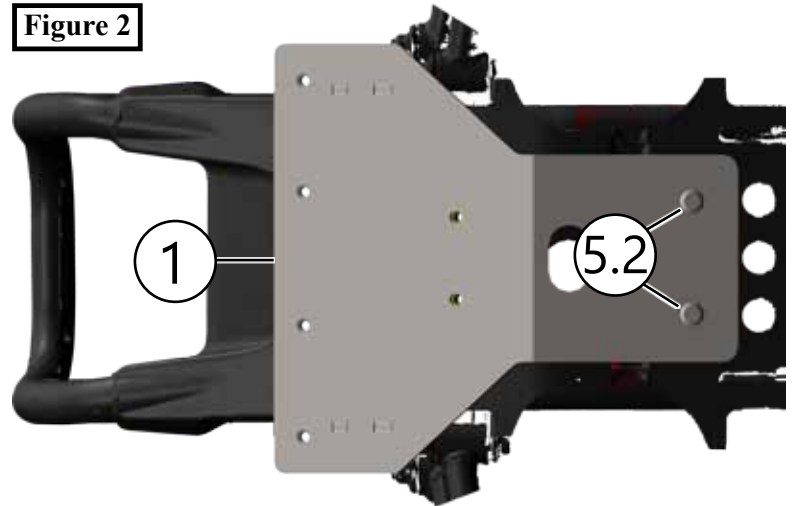

Figure 3

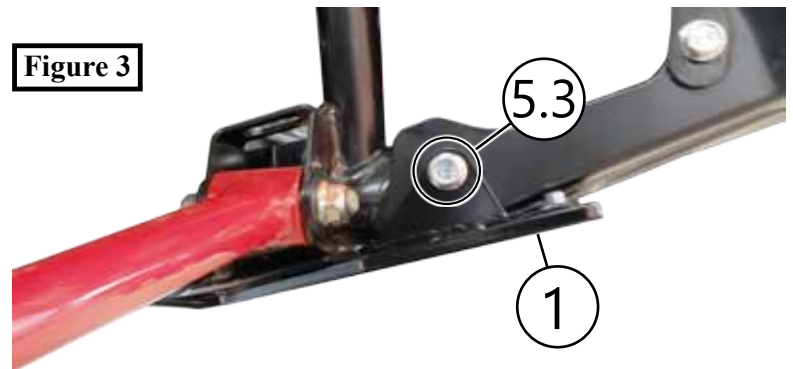

Figure 4

