

POLY PLOW BOX WING

Plow Accessory

PART #106120

Kit Components:		
Item #	Qty.	Description
1	1	Poly Plow Box Wing
2	3	Bushing
3	1	Box Wing Bracket
4	1	HK-364
4.1	2	5/16"-18 x 1.00" Carriage Bolt
4.2	1	5/16"-18 x 1.25" Carriage Bolt
4.3	3	5/16"-18 x 1.00" Hex Flange Bolt
4.4	2	5/16"-18 x 1.75" Hex Flange Bolt
4.5	1	5/16"-18 x 2.00" Hex Flange Bolt
4.6	6	5/16"-18 Hex Flange Nylock Nut
4.7	2	5/16"-18 Serr Hex Flange Nut

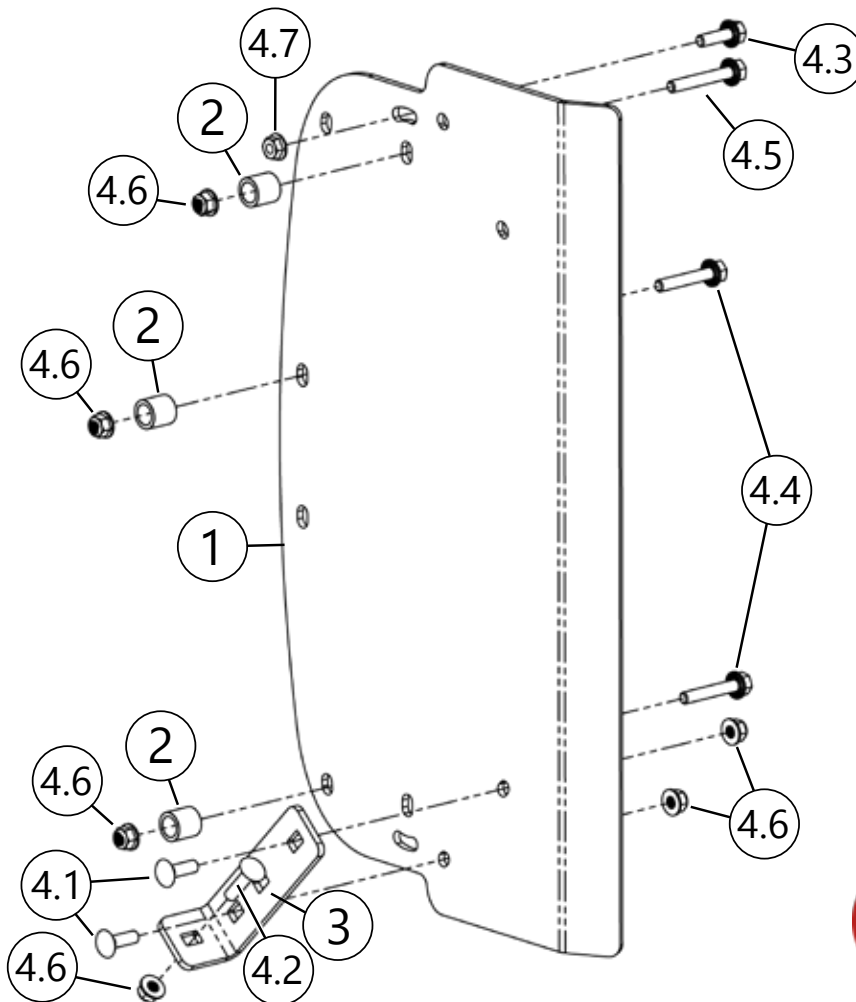

INSTALLATION INSTRUCTIONS:

Note: Make sure all hardware needed to complete this mount is in the package. Thoroughly read through and understand the instructions before installing.

Note: All steps in this manual are for the installation on the driver side of the plow blade. The Box wing is a symmetrical part and can be installed on either side. Mirror the Box Wing and repeat steps 1-7 for the passenger side.

1. Remove and discard the outermost wear bar carriage bolt on the driver side of the blade.
2. If already installed, remove the plow marker from the blade and set aside as it will be installed in a later step. Discard plow marker hardware as new hardware will be used from Box Wing kit.
3. Loosely install Box Wing Bracket (3) to Box Wing (1) using Bolts (4.1) and nuts (4.6) as shown in **Figure 1**.
4. Hold Box Wing in place and secure using the two shaded Bolts (4.4), Spacers (2), and nuts (4.6) as shown in **Figure 2**. **Note:** All spacers will get used between the box wing and the plow blade gusset.
5. Once Box Wing (1) is loosely installed, hold plow marker in place and secure using bolts (4.5 & 4.6), spacer (2), and nuts (4.6 & 4.7) as shown in **Figure 2**.
6. Secure Box Wing Bracket (3) to wear bar using bolt (4.2) and nut (4.6) as shown in **Figure 3**.
7. Tighten all hardware evenly.

