

HONDA PIONEER 1000 REAR BUMPER

Kit Components: PART # 101595

Item #	Qty.	Description
1	1	BUMPER
2	1	PASSENGER SIDE BRACKET
3	1	DRIVERS SIDE BRACKET
4	6	BED WASHER / SPACER
5	4	BUMPER CAPS
6	1	HK-347
6.1	6	5/16"-18 X 3/4" CARRIAGE BOLT-BLACK
6.2	10	5/16"-18 HEX FLANGED NYLOCK NUT
6.3	4	5/16-18 x 2 1/2" CARRIAGE BOLT
6.4	2	1/4-20 X 2" HEX BOLT
6.5	2	1/4-20 HEX FLANGE NYLOCK NUT
6.6	2	1/4" FLAT WASHER

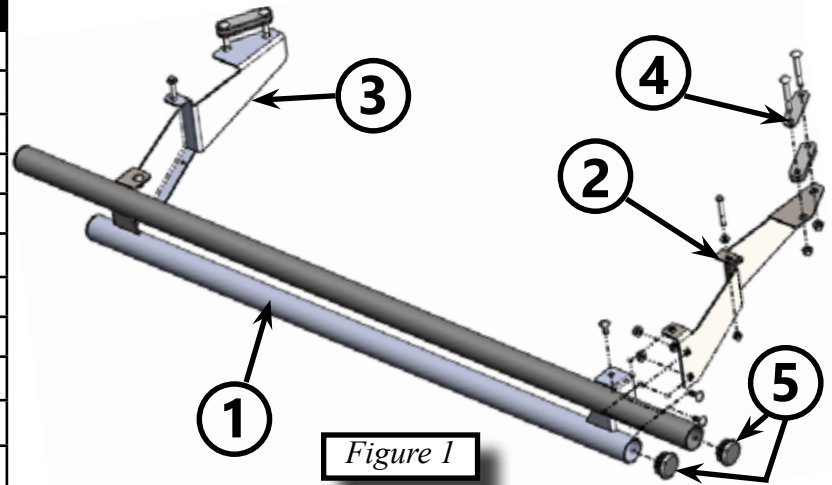

INSTALLATION INSTRUCTIONS:

- Note: Make sure all of the hardware needed to complete this mount is in the package. Read through and understand the instructions before installing. Drilling is required.*

- Assemble tube caps (5) to bumper tubes as shown in *Figure 1*.
- Remove phillips head screw (A) and drill though with a 9/32" drill bit (B) as shown in *Figure 2&3*.
- Locate bed frame hole (C) on passenger side under bed. Hole (C) will already be drilled through one wall thickness of the square tube frame. Use a 21/64" drill bit to drill hole (C) through tube frame into plastic bed as shown in *Figure 4*.
- Locate bed frame rail hole (D) on passenger side under bed. Hole (D) will be a hole though square tube frame. Use a 21/64" drill bit to drill hole (D) through and into plastic bed as shown in *Figure 4*.
- Repeat steps 2-4 on drivers side.

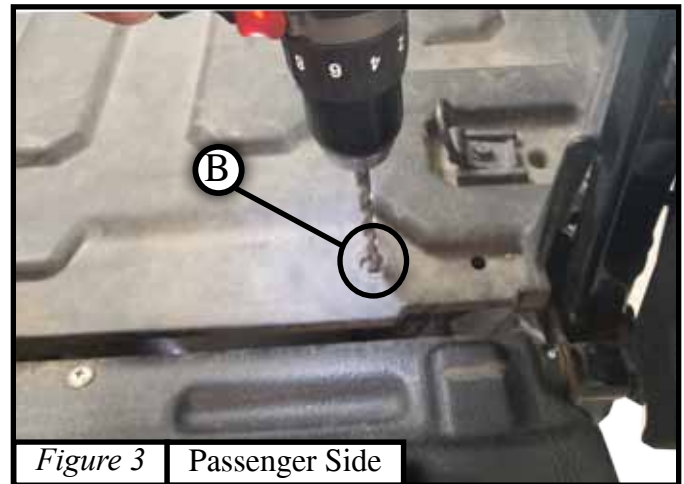

Figure 3 Passenger Side

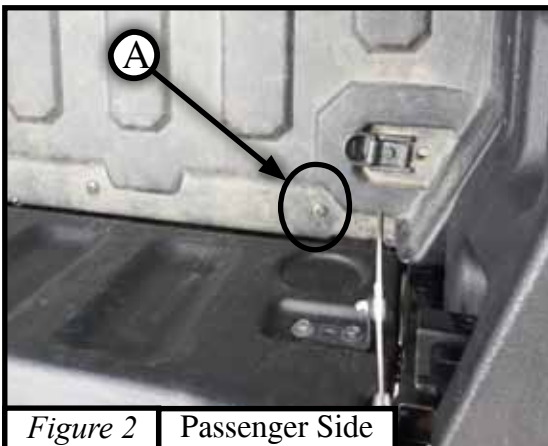

Figure 2 Passenger Side

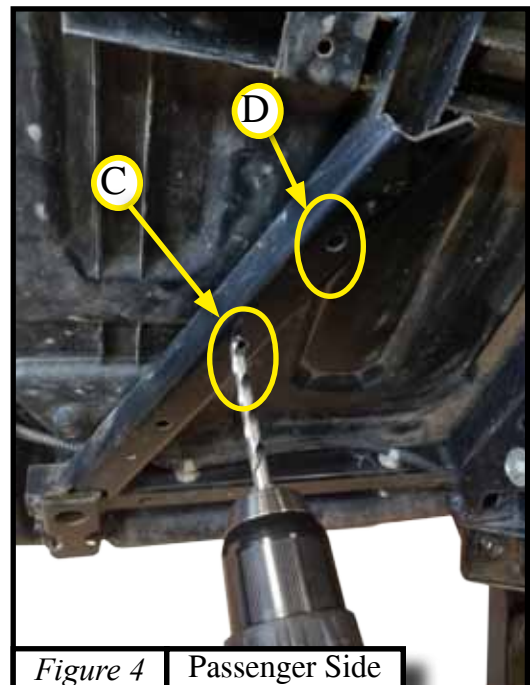

Figure 4 Passenger Side

6. Place two bed washer/spacer (4) between frame and bottom side a plastic bed as shown in figure *Figure 6*.
7. Place one bed washer/spacer (4) over holes (C-D) drilled in steps 3-4. Place two 5/16" x 2 1/2" Carriage Bolts through bed washer, plastic bed, frame and bumper bracket (2). Add two 5/16" Hex Flange Nylock Nuts as shown in figure *Figure 5 and 6*.
8. Place one 1/4" x 2.0 Hex Bolt (6.4) and washer (6.6) in hole (B) (drilled in step 2) through plastic bed, frame and bumper bracket (2). Add one 1/4" Hex Flange Nylock Nut as shown in figure *Figure 5 and 6*.
9. Repeat steps 6-8 on the driver's side of machine before installing bumper tube (1). Tighten all hardware evenly.
10. Bolt bumper (1) to bumper brackets (2&3) using six 5/16" x .75" Carriage Bolts BLK (6.1) and 5/16" Hex Flange Nylock Nuts (6.3) *Figure 6*.
11. Tighten all hardware evenly.

