

PIONEER 1000-5

Rear Bumper PART #101590

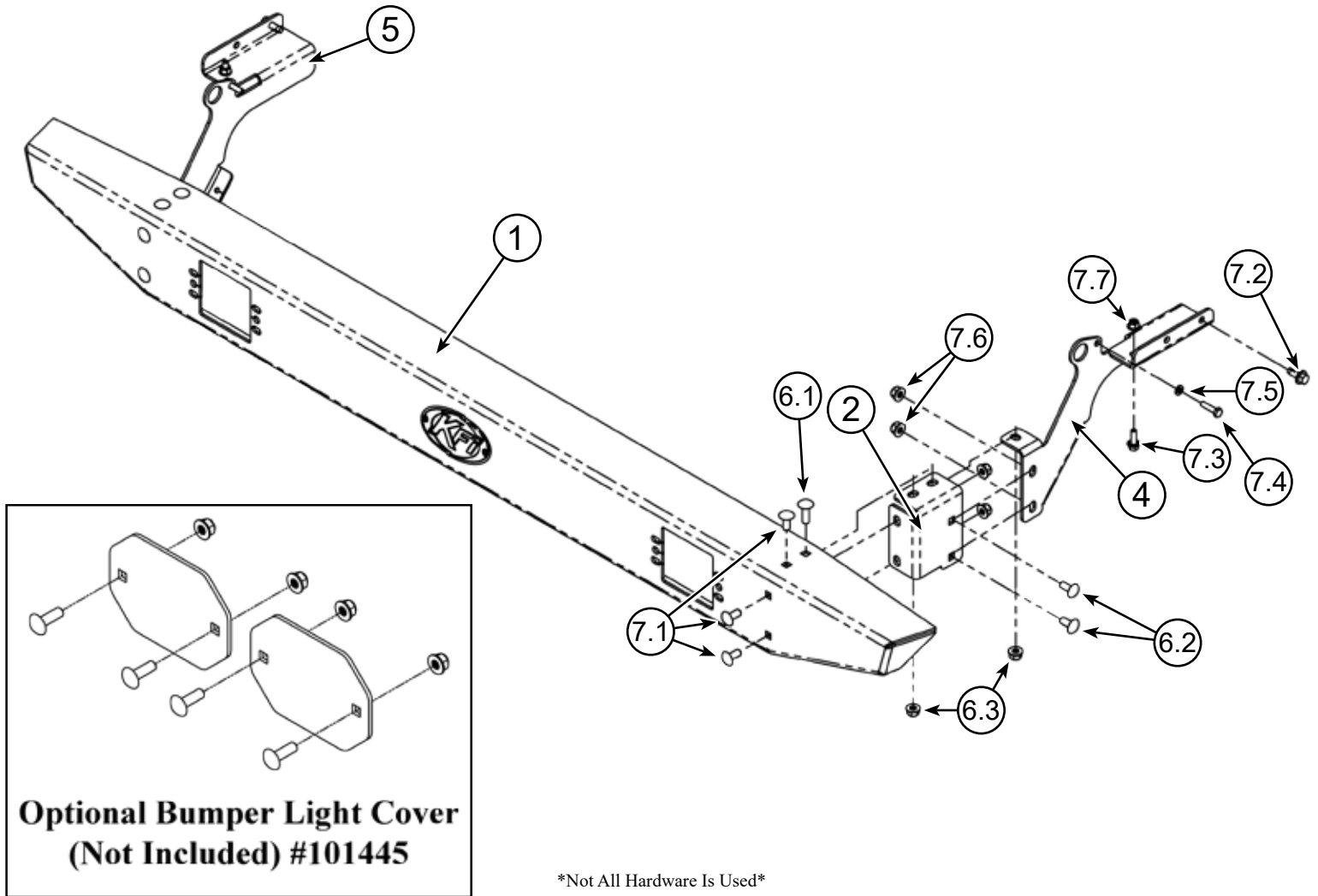

Not All Hardware Is Used

Kit Components:

Item #	Qty.	Description	Item #	Qty.	Description
1	1	Rear Bumper Formed	6.3	6	5/16"-18 Hex Nut Flange Nylock GR5
2	1	Passenger Side Conversion Bracket	7	1	Hardware Kit HK-322
3	1	Driver Side Conversion Bracket (Not Shown)	7.1	6	5/16"-18 x .75 Carriage Bolt Short Neck GR5 Black
4	1	Passenger Side Bumper Bracket	7.2	2	5/16"-18 x .75 Hex Bolt Flange Thread Cutting
5	1	Driver Side Bumper Bracket	7.3	2	1/4"-20 x .75 Hex Bolt Flange GR5 Serrated
6	1	Hardware Kit HK-342	7.4	2	M6-1.00 X 25 Hex Bolt GR8.8
6.1	2	5/16"-18 x 1.00 Carriage Bolt Short Neck GR5 Black	7.5	2	M6 Lock Washer
6.2	4	5/16"-18 x .75 Carriage Bolt Short Neck GR5	7.6	6	5/16"-18 Hex Nut Flange Nylock GR5
			7.7	2	1/4"-20 Hex Nut Flange Nylock GR5



INSTALLATION INSTRUCTIONS

Note: Make sure all hardware needed to complete this mount is in the package. Thoroughly read through and understand the instructions before installing.

1. Uninstall driver's side, rear door by removing four bolts (A) as shown in **Figure 1**.
2. Uninstall rear inner panel by removing three screws (B), hook bolt (C) and plastic push pin (D) as shown in **Figure 2**.

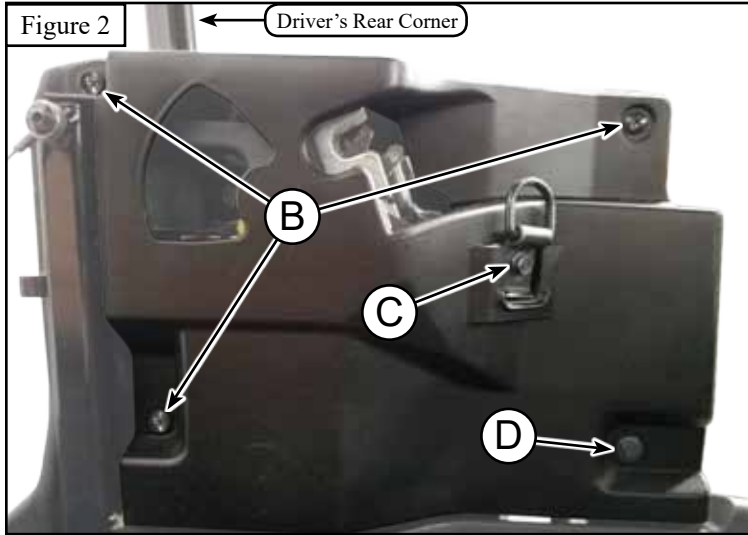
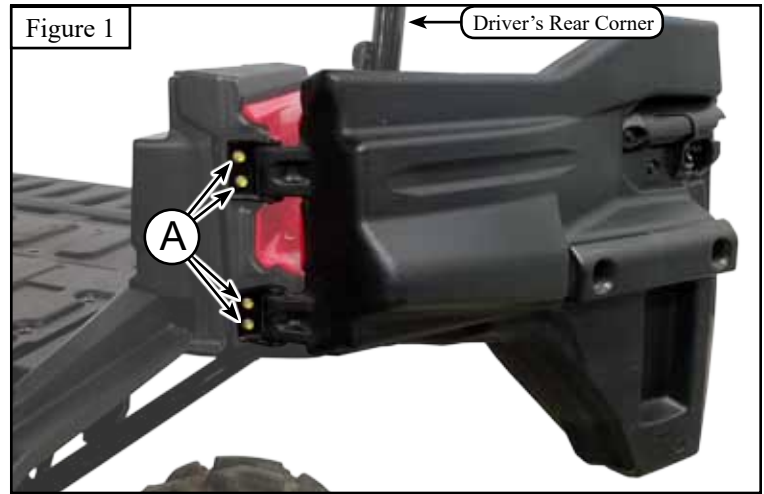

3. Uninstall rear light by removing two screws (E) and wire connector (F) as shown in **Figure 3**.
4. Uninstall rear outer panel by removing two bolts (G) as shown in **Figure 4**.
5. Remove hinge bolt (H) and plastic cap from the square tubing as shown in **Figure 5**.

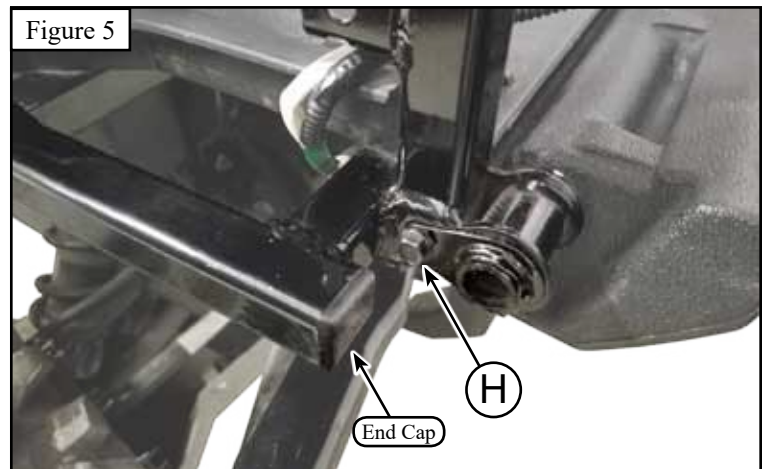
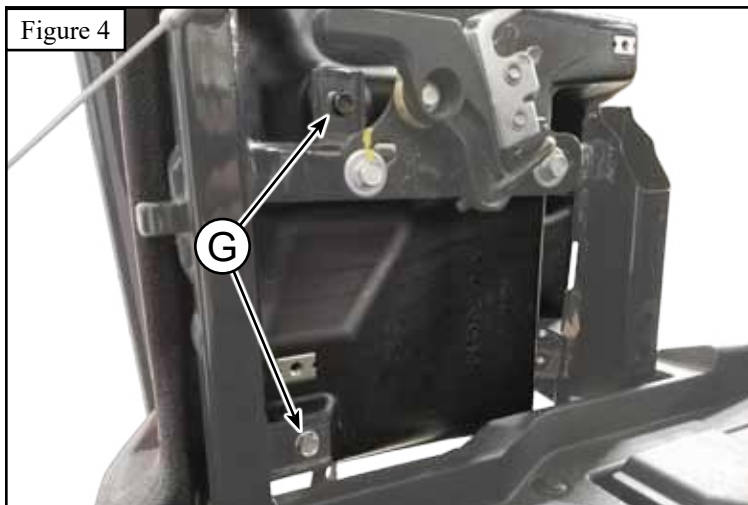
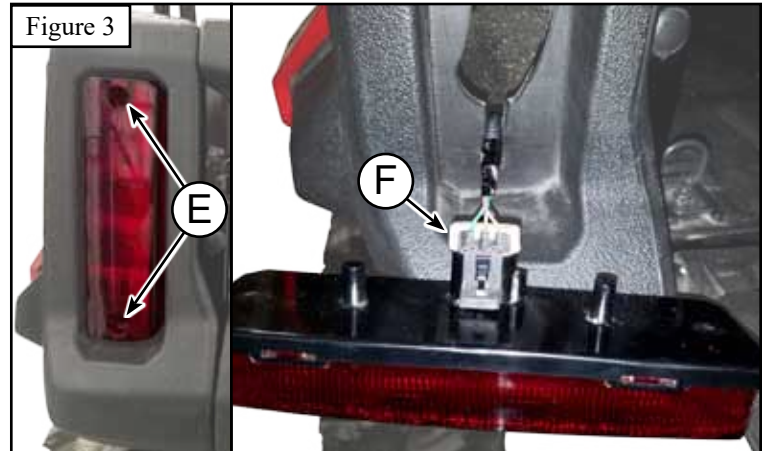

INSTALLATION INSTRUCTIONS

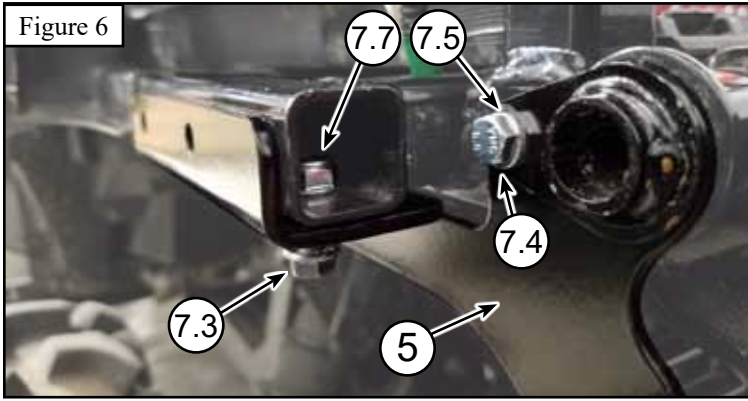

6. Remove hinge, then insert it through driver side bracket (5). Using M6 bolt (7.4) and washer (7.5), loosely install bracket as shown in **Figure 6**. *Note: M6 bolt will have an 8.8 marked on the head.*
7. Rotate bracket (5) upward to tubing and install bolt (7.3) and nut (7.7) as shown in **Figure 6**. Tighten all hardware evenly.
8. Repeat steps 1-7 on the passenger side of machine before installing Formed bumper (1).

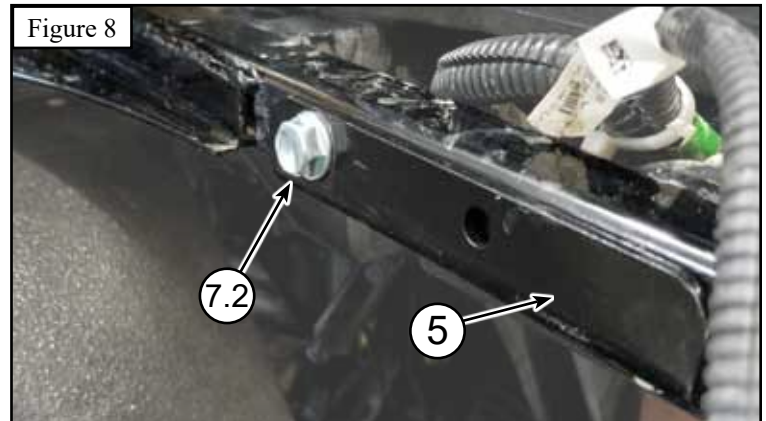
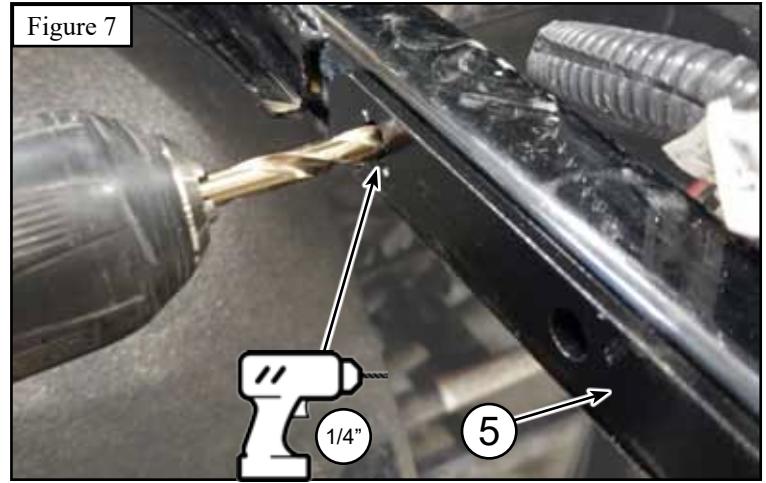

Optional Mounting (Requires Drilling)

9. Using 1/4" diameter drill bit, drill through the rear hole on the bracket (5) and into the tubing as shown in **Figure 7**. **ONLY DRILL THROUGH ONE SIDE OF THE TUBING.**
10. Install self threading bolt (7.2) as shown in **Figure 8**. It is recommended to **Hand Tighten** this screw so you do not strip anything.

11. To assemble bumper, locate the Formed Bumper (1) and Conversion Brackets (2 & 3). Install the Conversion Brackets onto the inside of the Formed Bumper with 3 black carriage bolts (7.1) and lock nuts (6.3) per side as shown at the top of **Figure 9**.
12. Set the Bumper Assembly onto the Bumper Brackets (4 & 5) and secure using bolts (6.1 & 6.2) and nuts (7.6) as shown in the bottom of **Figure 9**.
13. Level bumper and tighten all hardware evenly.

Note: The zip tie locations (Figure 9) can be used to secure the wires for cube lights.

