

POLARIS RANGER SP 570

Winch Mount

PART #101980

Kit Components:		
Item #	Qty.	Description
1	1	Winch Mount
2	1	Hardware Kit (HK-031)
3	1	Hardware Kit (HK-391)
3.1	4	3/8"-16 x 1.00 Hex Flange Bolt
3.2	4	3/8"-16 Hex Flange Nylock Nut
3.3	4	3/8"-16 Square Nut (not used)

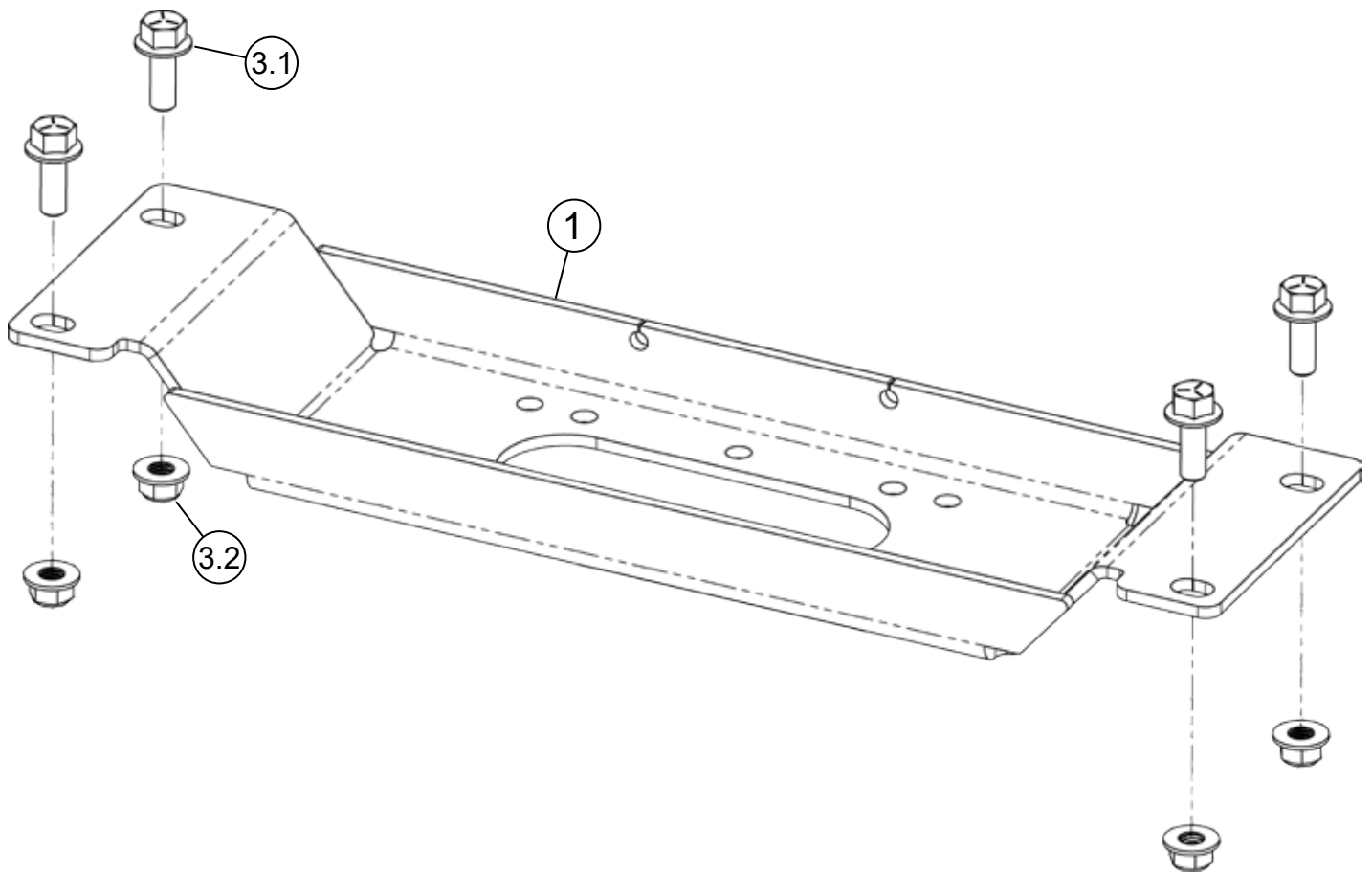

INSTALLATION INSTRUCTIONS

Note: Make sure all hardware needed to complete this mount is in the package. Thoroughly read through and understand the instructions before installing.

1. Remove front bumper by removing OEM bolts (A) found on the back side of the front bumper as shown in **Figure 1**.
2. Assemble winch and contactor to winch mount (1) using hardware supplied with the winch as shown in **Figure 2**. See **Figure 3** for wide, standard, and 2-hole winch mounting patterns. **NOTE:** Make sure winch cable is spooling out between the winch drum and winch mount (1) as shown in **Figure 2**.
3. Assemble winch fairlead to front bumper using hardware supplied with the winch as shown in **Figure 4**.
4. Assemble winch mount (1) to front bumper supports using bolts (3.1) and nuts (3.2) as shown in **Figure 5**.
5. Reattach front bumper to the machine using OEM bolts (A) removed in step 1.

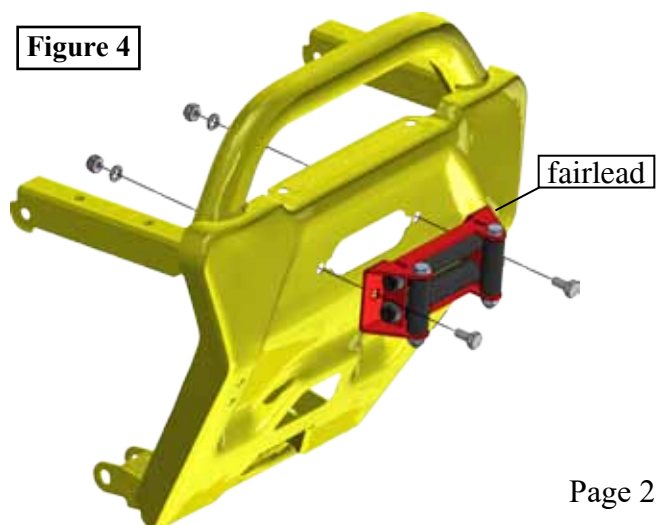
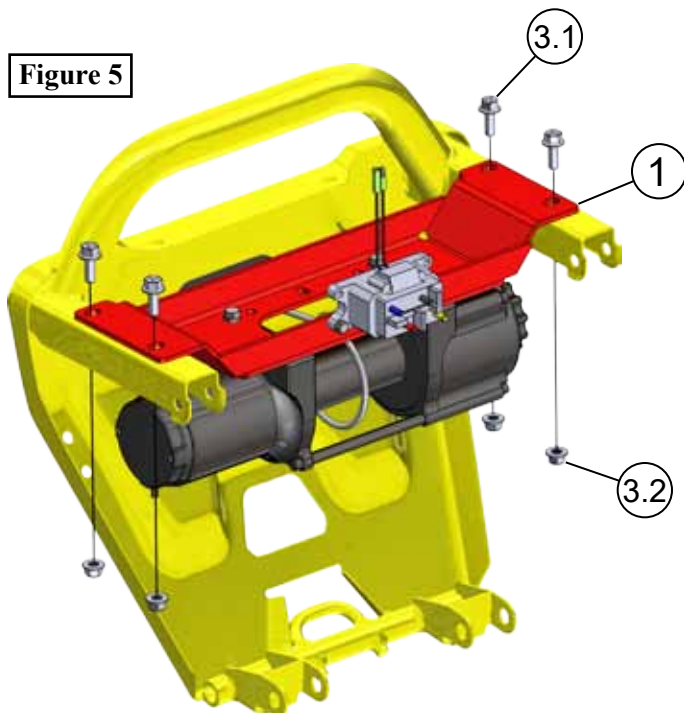
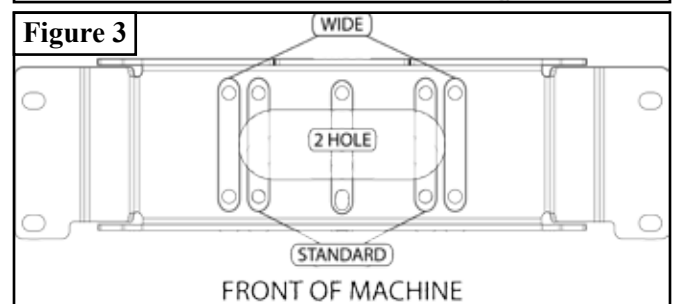
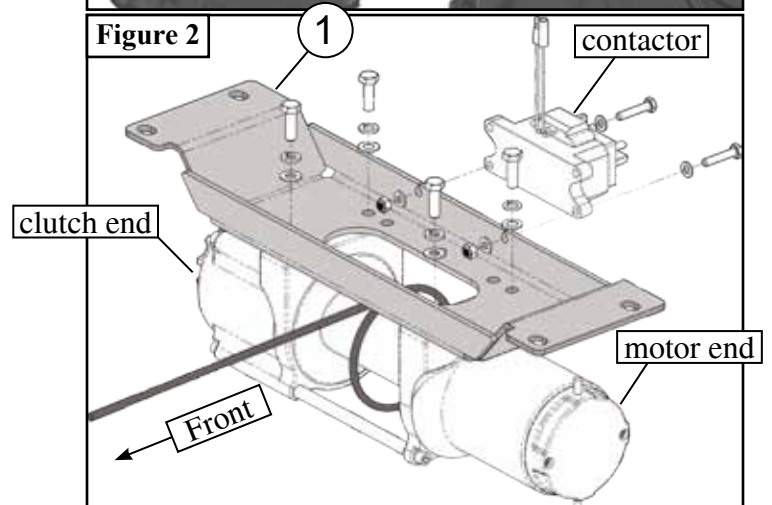
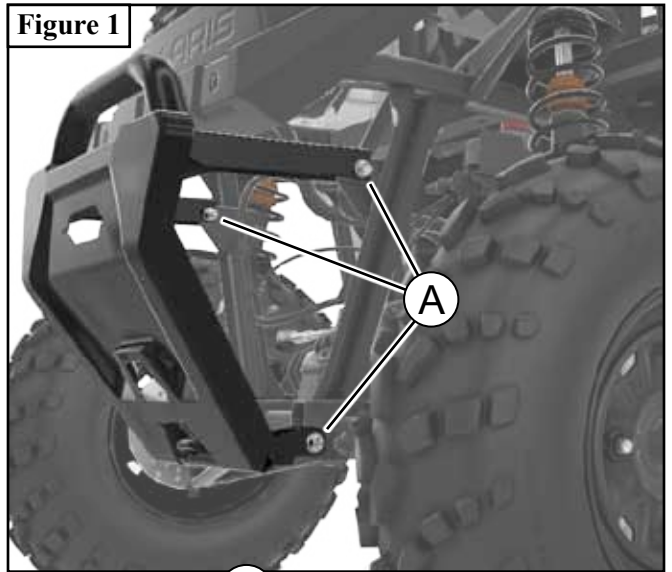

WIRING INSTRUCTIONS

1. Run the red positive (+) battery wire from the contactor to the positive (+) post on the pulse bar. Run the black ground wire (-) from the contactor to the ground (-) post on the pulse bar as shown in **Figures 6 & 7**.
 2. In the center console of the ranger, there are pre-notched holes for the dash rocker switch to mount as shown in **Figure 8 & 9**.
- NOTE: If the winch only comes with a handlebar mounted rocker switch you and wish to install it in the dash, assemble per **Figure 10** using hardware kit HK-031 (3).
3. If the Polaris 3-pin wire harness for the pulse bar is not being used, attach the ignition fed (red) wire from the switch to the orange wire (B) as shown in **Figure 7**.
 4. Using the wiring instructions provided in the winch manual, wire accordingly.

