



# INSTALLATION INSTRUCTIONS BUMPER WINCH MOUNT KIT

Part Number: 103420

Application: 2019 Polaris RZR Turbo S

## GENERAL SAFETY PRECAUTIONS

Your safety, and the safety of others, is very important. To help you make informed decisions about safety, we have provided installation and operating instructions and other information on labels and in this guide. This information alerts you to potential hazards that could hurt you or others. It is not possible to warn you about all potential hazards associated with this product, you must use your own good judgment.

**CARELESS INSTALLATION AND OPERATION CAN RESULT IN SERIOUS INJURY OR EQUIPMENT DAMAGE. READ AND UNDERSTAND ALL SAFETY PRECAUTIONS AND OPERATING INSTRUCTIONS BEFORE INSTALLING AND OPERATING THIS PRODUCT.**

This guide identifies potential hazards and has important safety messages that help you and others avoid personal injury or death. WARNING and CAUTION are signal words that identify the level of hazard. These signal words mean:

▲WARNING signals a hazard that could cause serious injury or death, if you do not follow recommendations. ▲CAUTION signals a hazard that may cause minor to moderate injury, if you do not follow recommendations.

This guide uses NOTICE to call attention to important mechanical information, and Note: to emphasize general information worthy of special attention.

### ▲ WARNING

#### IMPACT AND MOVING PARTS ENTANGLEMENT HAZARD

Failure to observe these instructions could lead to severe injury or death

- **Always** take time to fully read the Instructions and/or Operations Guide, and/or Basic Guide to Winching Techniques, in order to understand your winch and its operations.
- **Always** use extreme caution when drilling on any vehicle. Make sure that all fuel lines, brake lines, electrical wires, and other objects are not punctured or damaged when/if drilling on the vehicle. Thoroughly inspect the area to be drilled (on both sides of material) prior to drilling, and relocate any objects that may be damaged. Failure to inspect the area to be drilled may result in vehicle damage, electrical shock, fire or personal injury.
- **Always** wear safety glasses when installing this kit. A drilling operation will cause flying metal chips. Flying chips can cause eye injury.
- **Always** use extreme caution when cutting and trimming during fitting.
- **Always** remove jewelry and wear eye protection.
- **Never** lean over battery while making connections.
- **Never** route electrical cables:
  - o Across any sharp edges.
  - o Through or near moving parts.
  - o Near parts that become hot.
- **Always** insulate and protect all exposed wiring and electrical terminals.
- **Always** install terminal boots as directed in installation instructions.
- **Always** use appropriate and adequate care in lifting components into place.
- **Always** insure components will remain secure during installation and operation.
- **Always** tighten all nuts and bolts securely, per the installation instructions.
- **Always** perform regular inspections and maintenance on the plow mechanism, fasteners, cable and related hardware.
- **Always** replace all worn or damaged parts before operating.
- **Never** operate this WARN product with damaged or missing parts.

Read installation and operating instructions thoroughly.

WARN INDUSTRIES, INC. 12900 S.E. Capps Road,  
Clackamas, OR USA 97015-8903, 1-503-722-1200, FAX: 1-503-722-3000  
Customer Service: 1-800-543-9276  
Dealer Locator Service: 1-800-910-1122  
International Fax: 1-503-722-3005

## **⚠ CAUTION**

### **MOVING PARTS ENTANGLEMENT HAZARD**

**Failure to observe these instructions could lead to minor or moderate injury**

- **Always** take time to fully read and understand the installation and Operations Guide included with this product.
- **Never** operate this product if you are under 16 years of age.
- **Never** operate this product when under the influence of drugs, alcohol or medications.

**Read installation and operating instructions thoroughly.**

## **NOTICE**

### **EQUIPMENT DAMAGE**

- **Always** refer to the Installation and Specification Guide, supplied in the winch kit, for all wiring schematics and specific details on how to wire this WARN product to your vehicle.

**Read installation and operating instructions thoroughly.**

## **NOTES**

## **BEFORE YOU BEGIN**

## **TABLE OF CONTENTS**

Tools Required.....	page 2
Parts List.....	page 3
Torque Specifications.....	page 3
Installation.....	page 4-7
Maintenance/Care.....	page 7

## **TOOLS REQUIRED**

- Metric Wrenches and Sockets
- Standard Wrenches and Sockets
- Socket extension

## PARTS LIST

ITEM	PN	DESCRIPTION	QTY	ITEM	PN	DESCRIPTION	QTY
A1	103418	UPPER BUMPER SUPPORT	1	B1	92506	M10 X 1.25 NYLOC NUT	2
A2	103390	BUMPER MOUNT	1	B2	93104	M8-1.25 x 25 FLANGE BOLT	4
A3	103419	LOWER BUMPER SUPPORT	1	B3	79464	M12 x 1.75 x 25 BOLT	2
A4	102527	LIGHT MOUNT BRACKET	1	B4	79465	M12 x 1.75 FLANGE NUT	2
A5	102229	FAIRLEAD BRACKET PLATE	1	B5	71588	M8 x 1.25 FLANGE NUT	5
				B6	78408	M10X1.25X25 FLANGE BOLT	2
				B7	65970	M8-1.25 x 25 FLANGE BOLT	5

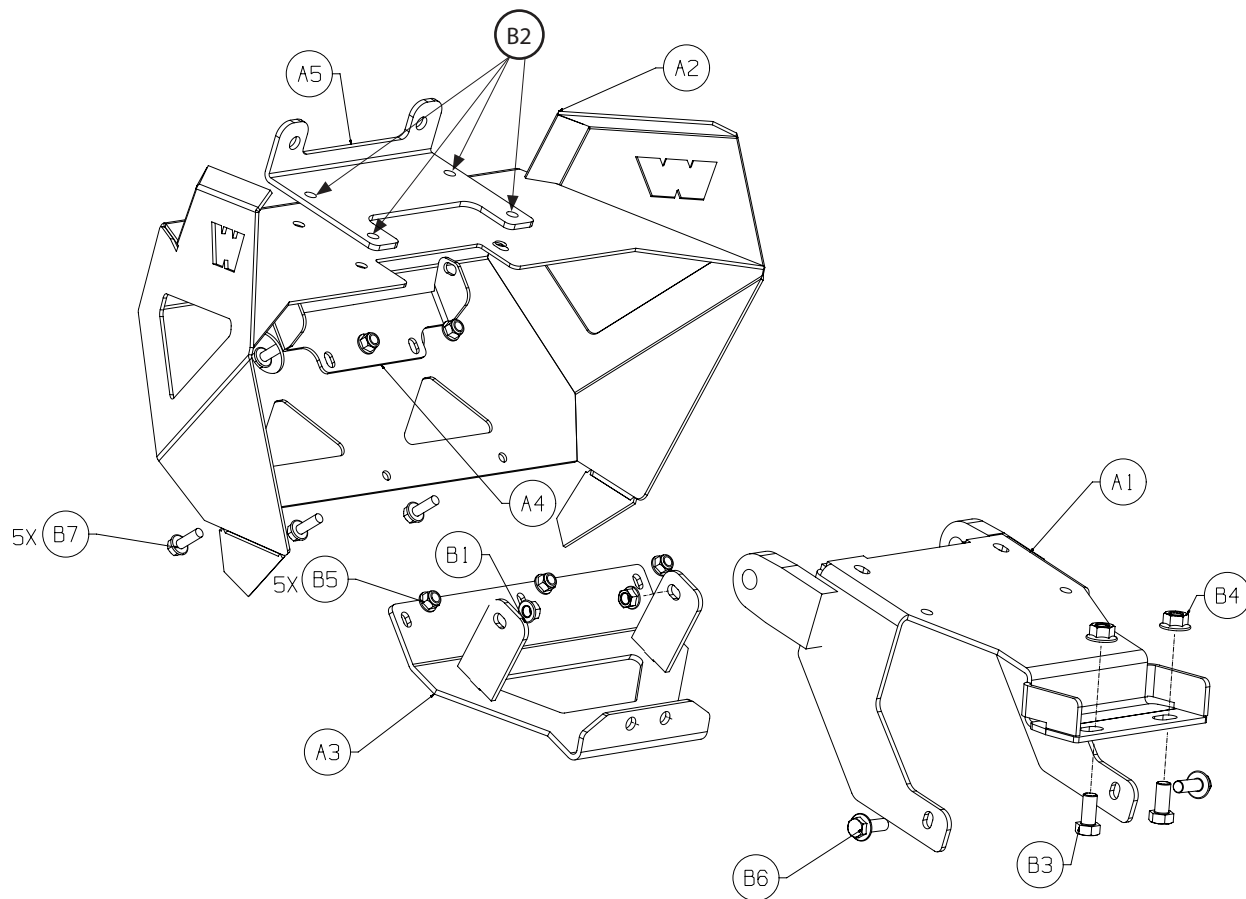

## TORQUE SPECIFICATIONS

Please use the recommended torque specifications when assembling this product unless otherwise specified in the instructions.

FASTENER SIZE	FASTENER TORQUE		FASTENER SIZE	FASTENER TORQUE	
	lb-ft	(N.m)		lb-ft	(N.m)
1/4"	8	(11)	M4	(2)	3
5/16"	17	(23)	M5	(4.5)	6
3/8"	30	(40)	M6	(7.5)	10
7/16"	48	(66)	M8	(18)	25
1/2"	74	(100)	M10	(37)	50
9/16"	106	(144)			
5/8"	148	(200)			
3/4"	269	(364)			

## INSTALLATION INSTRUCTIONS

1. From the front center of the vehicle, remove the tow loop (two bolts). **NOTE: There is a nut plate behind the frame. Place a finger on top of the tab so the plate will not fall behind the bottom of the skid pan. If nut plate should fall, see step 4.**

Retain hardware for later reuse.

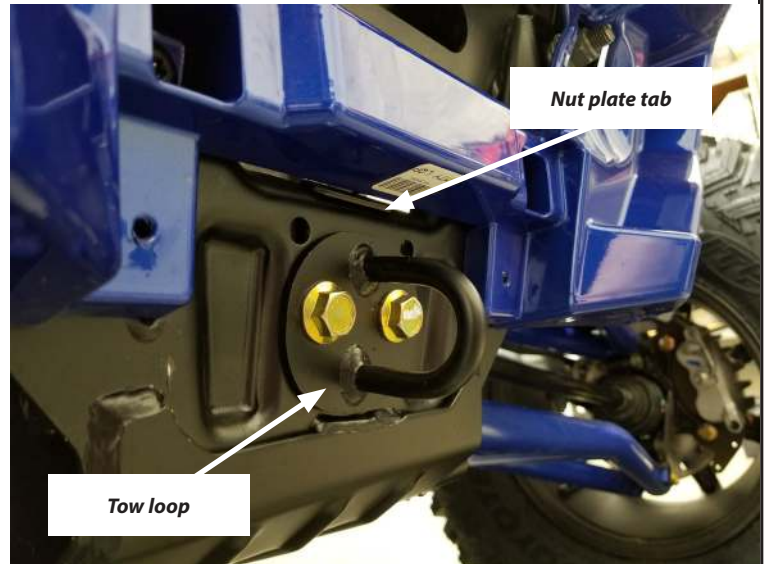

2. Remove grill by depressing tabs and pull towards you.
3. Remove the torx head screws for the lower plastic and unsnap the top of the plastic from the vehicle.



4. If nut plate should fall in step one, remove the two torx head screws shown. Pull outward on plastic and retrieve the nut plate with a magnet.

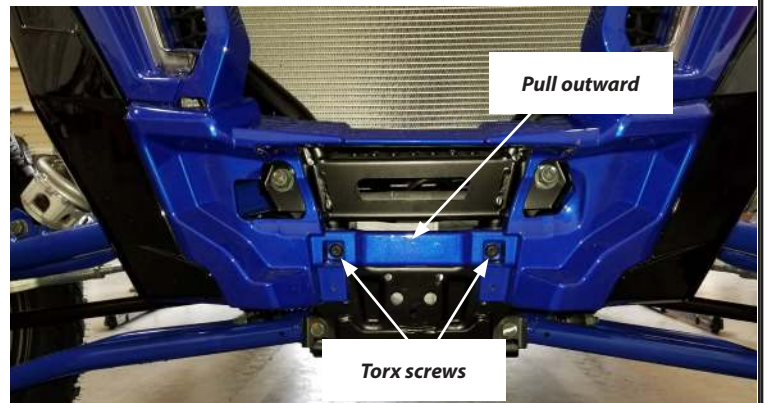

## INSTALLATION INSTRUCTIONS

5. While holding nut plate in place, install the lower bumper support (A3) using the factory tow loop bolts you removed in step one. **Do not tighten completely to allow for adjustment.**

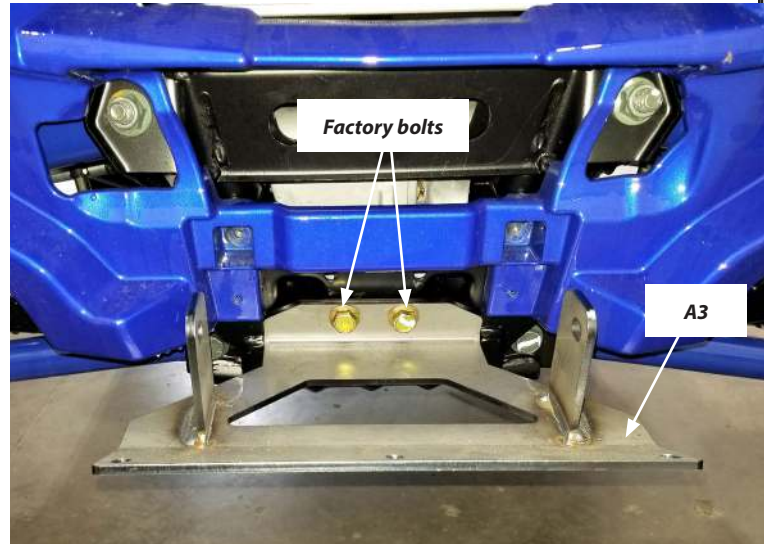

6. Attach the upper bumper support (A1) using the M12 hardware (B3 & B4). **NOTE: Slide the bolt up through the frame and attach the nut topside. Do not tighten completely to allow for adjustment.**

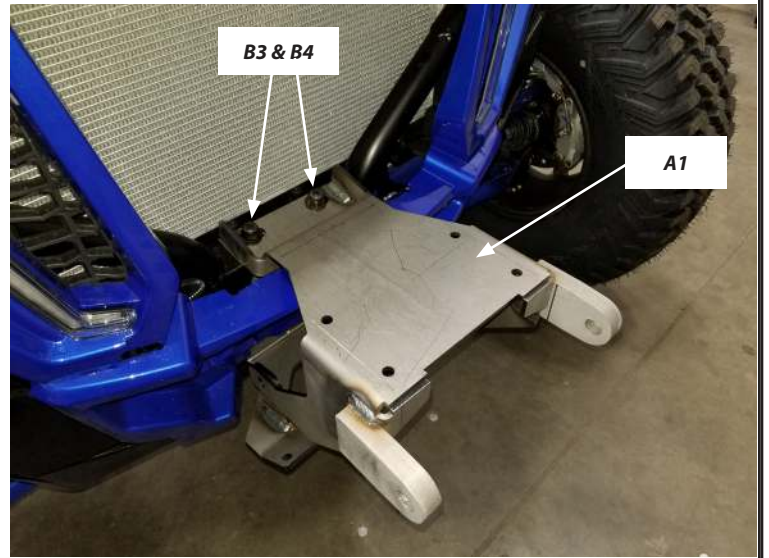

5. Install one M10 bolt (B6) through the outer side of the upper bumper support metal flange and lower bumper support mounting holes. Secure with a M10 nut (B1).
6. Repeat for other side.
7. Tighten all hardware now.

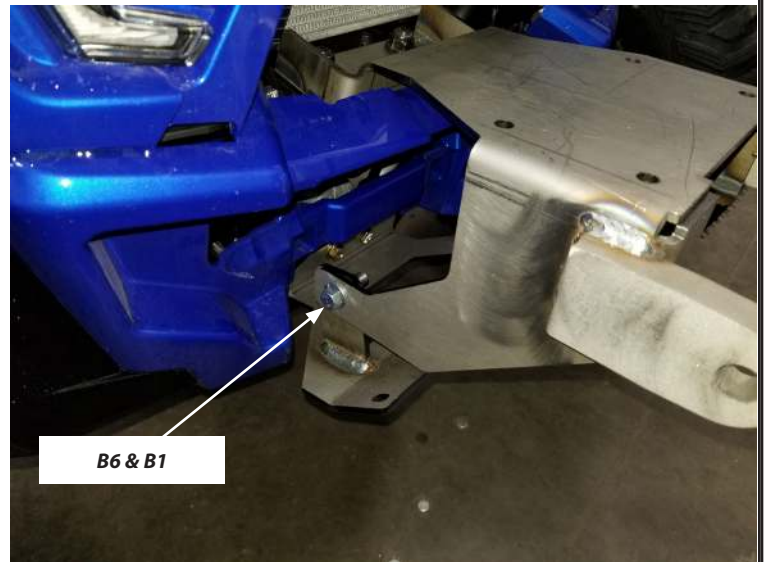

## INSTALLATION INSTRUCTIONS

- Slide the bumper mount over upper bumper support being sure to align the top four winch mounting holes with upper bumper support.



- Reinstall grille.
- Install fairlead to fairlead bracket plate, using hardware in your winch kit.
- Place fairlead bracket plate assembly over the holes in the bumper mount.

**NOTE:** *Install the winch electrical cables to the winch prior to installation.*

- Place the winch on top of the fairlead plate.
- Mount the winch using the four M8 bolts (B2), **included in this kit**. TIP: Use a drive socket with long extension through the access holes supplied in your bumper. Do not tighten completely.



19. Install three M8 flange bolts (B7) through the bottom of the bumper and the lower bracket. Secure with M8 locking nuts (B5). Do not tighten completely.

20. Tighten winch mounting bolts now to torque specifications on page 3.

21. Tighten lower three bolts now.

*Tip: You may want to install your lights to your light bar before installing.*

22. From behind the bumper shell, install the light mounting bracket (A4) using two M8 flange bolts (B7) and locking nuts (B5).

23. Complete your winch wiring following your wiring installation instructions supplied with your winch.

24. Installation is complete.



## MAINTENANCE / CARE

1. Inspect all parts on the winch, winch mount, and related hardware prior to each use. Replace all hardware that appears rusted or deformed.
2. Inspect all nuts and bolts on the winch, winch mount,, and related hardware prior to each use. Tighten all nuts that appear to be loose. Stripped, fractured, or bent bolts or nuts need to be replaced.
3. Check all cables prior to use. Replace cables that look worn or frayed.
4. Check all moving or rotating parts. Remove debris that may inhibit the part from moving freely.

**CARELESS INSTALLATION AND OPERATION CAN RESULT IN SERIOUS INJURY OR EQUIPMENT DAMAGE. READ AND UNDERSTAND ALL SAFETY PRECAUTIONS AND OPERATING INSTRUCTIONS BEFORE INSTALLING AND OPERATING THIS PRODUCT.**

