

(3) 1/8 THICK SHIM

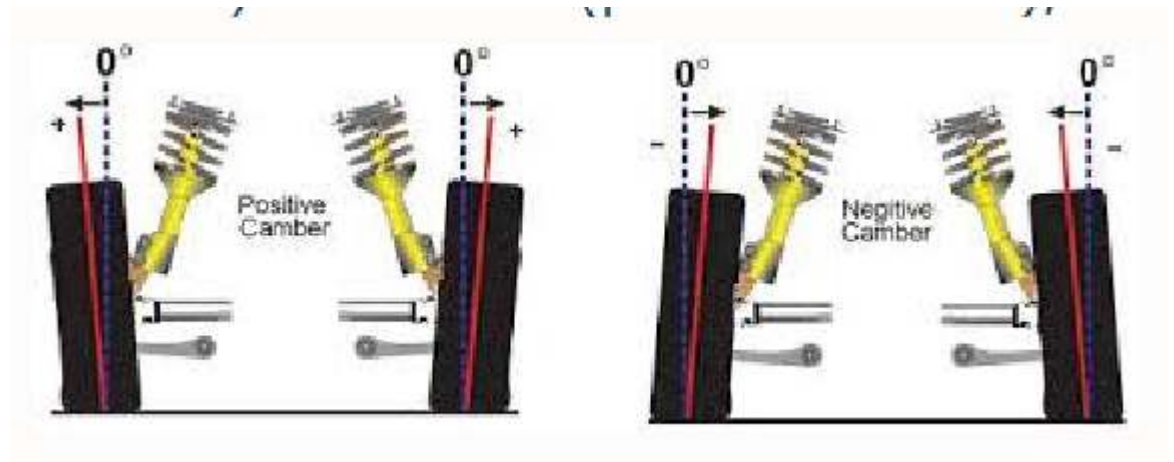

(2) 1/16 THICK SHIM



ZERO

POSITIVE

NEGATIVE

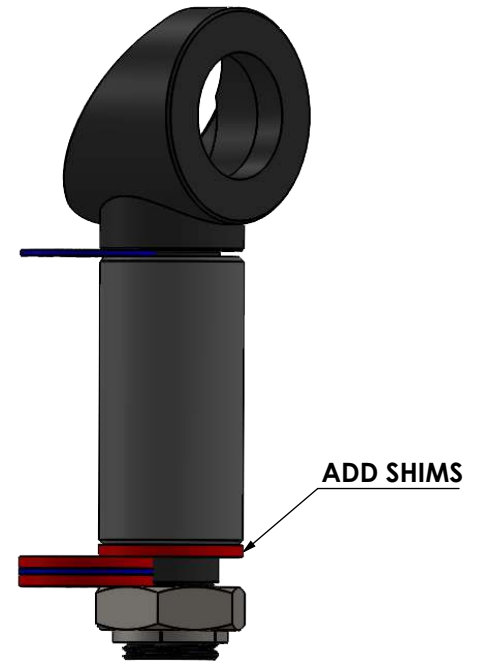
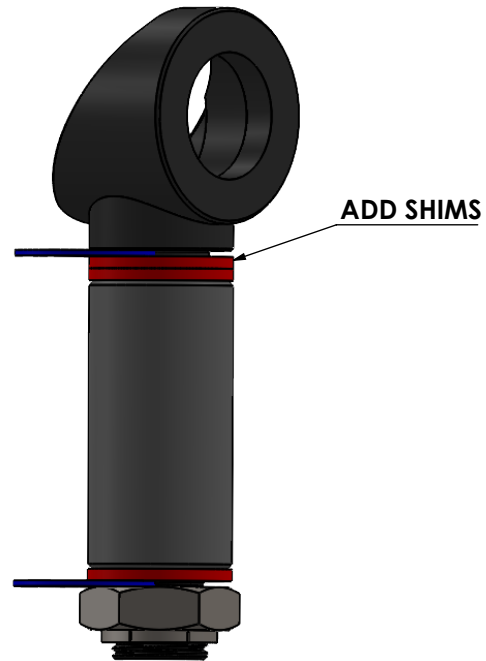
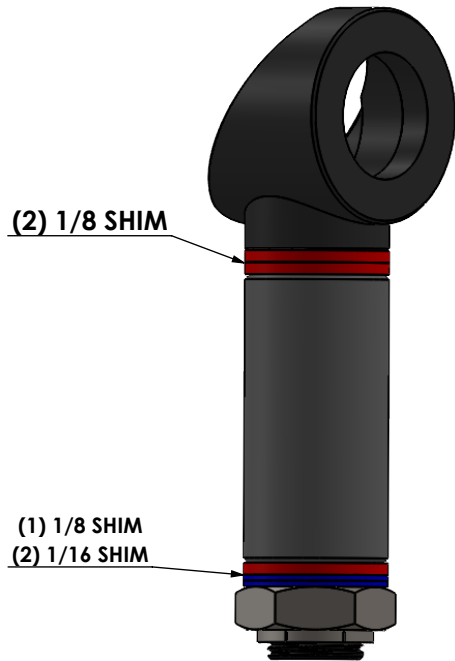

NUT TORQUE: 150 FT-LBS

UNLESS OTHERWISE SPECIFIED:

DIMENSIONS ARE IN INCHES
 TOLERANCES:
 FRACTIONAL: $\pm 1/16$
 ANGULAR: MACH ± 1 , BEND ± 5
 TWO PLACE DECIMAL: $\pm .01$
 THREE PLACE DECIMAL: $\pm .005$



DRAWN: CHET G.

TITLE:

CAMBER ADJUSTMENT

MATERIAL

SCALE: 1:5

WEIGHT:

SHEET 1 OF 1